

SOCIAL CHANGE AND RESISTANCE



LOOKING BACK TO MOVE FORWARD



OCTOBER 16-19, 2024

MILLENNIUM MAXWELL HOUSE HOTEL
2025 ROSA L PARKS BLVD
NASHVILLE, TN

Theresa Davidson, PhD - President
Melencia Johnson, PhD - President Elect and Program Chair

ABOUT THE COVER ARTIST

Marcus Brooks is an Assistant Professor of Sociology and Program Coordinator for Citizenship and Social Justice at Western Kentucky University. He serves as the Chair of the MSSA Technology Committee. He holds a BA from Austin Peay State University, an MA from Middle Tennessee State University and a PhD from The University of Cincinnati.

Photo Credits for the Cover Art

Top Left: John Lewis marching in front of the state capitol building, 1963. (Photo credit: Frank Empson)

Top Right: Protestors demonstrating at Nashville Police Department, 1961. (Photo credit: Eldred Reaney)

Bottom Left: Young people protesting Covenant school shooting, 2023. (Photo Credit: John Partipilo)

Bottom Right: Black Lives Matter protesters at the state capitol building, 2020. (Photo Credit: Jason Kempin)

SPECIAL THANKS TO THE 2024 PROGRAM COMMITTEE

President: Theresa Davidson, Samford University

Chair: Melencia Johnson, University of South Carolina Aiken

Marcus Brooks, Western Kentucky University

Harry Dahms, University of Tennessee, Knoxville

Meredith Dye, Middle Tennessee State University

Tina Deshotels, Jacksonville State University

Giselle Greenidge, Northwest Missouri State University

Andrea Hunt, University of North Alabama

David May, Mississippi State University

DeMond Miller, Rowan University

Lauren Norman, University of North Carolina Pembroke

Erin Rider, Nevada State University

Matthew Schneider, University of North Carolina Wilmington

Andrew Tatch, Troy University





Purpose

The Mid-South Sociological Association (MSSA) is a nonprofit professional organization which promotes the study and understanding of sociological and related issues and problems. Professional interests include crime, aging, deviance, demography, environment, family, education, race and ethnic relations, religion, global and community development, occupations, health, inequality, gender, corrections, community, political economy, science and technology, urban/rural, law, ecology, and others.

Membership

The membership comprises sociologists and other social scientists who come from colleges and universities, various levels of government, and nonprofit social agencies. Membership policy imposes no geographical restrictions. All professionals with interests in sociological and social science topics are welcome as members. Membership dues include a subscription to the journal, *Sociological Spectrum*, and the Forum newsletter.

Meetings

Membership in the MSSA and participation in annual meetings offer advantages to sociologists, social scientists, related professionals, and students of sociology. These advantages include exposure to current research on various social topics with opportunities for interactions, networking, and engagement in dialogue on social research issues and problems of mutual interest. The meetings provide a medium for dialogue on research and professional development issues of concern to the discipline and the larger community. Meetings of the MSSA are held annually and are hosted by colleges and universities in different states in the mid-South region.

Publications

The scholarly, refereed journal, *Sociological Spectrum*, is published six times per year. Manuscripts are submitted to the editor and then enter the review process. Articles focusing on the sociological analysis of various social conditions, problems, issues, and solutions in the United States and abroad are welcome. Forum, the MSSA newsletter, is published twice per year.

SCHEDULE AT A GLANCE

(All times Central Daylight Time)

#	Title	Start	End	Room
Wednesday, October 16				
	Executive Council Meeting	1:00 PM	2:00 PM	Polk
1	Crime and Criminology- Challenges to Reentry for Incarcerated Persons	2:00 PM	3:15 PM	Embassy East
2	Undergraduate Research I	2:00 PM	3:15 PM	Embassy West
3	Digital Sociology	2:00 PM	3:15 PM	International
4	Socio-political Contexts: Race, Class, Gender and Deviance	3:30 PM	4:45 PM	Embassy West
5	50th Commemorative Panel I: Sociology, 50 Years Forward	3:30 PM	4:45 PM	Embassy East
6	Applying to Ph.D. and MA programs - Sponsored by the Committee on Professions	3:30 PM	4:45 PM	International
	Professional Headshots	3:30 PM	4:45 PM	Jackson
	Welcome Reception: 50th Anniversary Kick-Off (Limited complimentary appetizers and beverages)	5:00 PM	6:30 PM	Grand Ballroom Central
Thursday, October 17				
	Breakfast	7:30 AM	9:30 AM	Grand Ballroom East
	Sociological Theory Caucus Breakfast - Theory Mini Conference	8:30 AM	9:15 AM	Grand Ballroom East
7	Vaxxers, Preppers, and Immunizers: Where is the dis"pair"ity?	8:00 AM	9:15 AM	Embassy East
8	Death, Dying, and Disease Studies	8:00 AM	9:15 AM	Embassy West
9	Potpourri: Immigration, Environment, Drug Use	8:00 AM	9:15 AM	Forum West
10	Arts In Movement: Courageous 8	8:00 AM	9:15 AM	Forum East
11	Politics, Social Movements, and Social Change	9:30 AM	10:45 AM	Embassy East
12	Navigating the Dynamic Landscape of Social Interaction in the Digital Age	9:30 AM	10:45 AM	Embassy West
13	Critical Sociology and the Politics of Fear - Theory Mini-Conference	9:30 AM	10:45 AM	Forum West
14	Teaching Sociology and Criminology	9:30 AM	10:45 AM	International
15	Crime and Criminology- White Collar Crime and Ethical Use of Private Data	11:00 AM	12:15 PM	Embassy East
16	Environment and Society	11:00 AM	12:15 PM	Embassy West
17	Critical Criminology, Critical Criminology, Critical Sociology, and Critical Theory in/of America - Theory Mini-Conference	11:00 AM	12:15 PM	Forum West
18	Navigating Tenure and Promotion in Academia	11:00 AM	12:15 PM	International
19	Gender and Sexualities Roundtable	11:00 AM	12:15 PM	Polk
20	Building on Du Bois' Sociological Approach to Address Health Disparities at the Neighborhood Level	11:00 AM	12:15 PM	Forum East
21	Education as Empowerment: How can we support immigrant students?	12:30 PM	1:30 PM	International Grand Ballroom
22	Women, Gender, and Sexualities Caucus Luncheon	12:30 PM	1:30 PM	East
22	Media, Politics, and Inequality	2:00 PM	3:15 PM	Forum East
23	Sociological Theory: Fine Arts, Objects, and Social Breakdown - Theory Mini-Conference	2:00 PM	3:15 PM	Forum West

SCHEDULE AT A GLANCE

(All times Central Daylight Time)

#	Title	Start	End	Room
24	AI, Scholarship, and Teaching: Creative Tools for Learning and Teaching	2:00 PM	3:15 PM	Jackson
25	Criminology Research in Progress Roundtable	2:00 PM	3:15 PM	Polk
26	Research Methods in the Current Era of COVID-19	2:00 PM	3:15 PM	Embassy East
27	Black Women's Resistance through Persistence	2:00 PM	3:15 PM	Embassy West
28	Criminal Legal System	3:30 PM	4:45 PM	Embassy West
29	Sociology of Disaster	3:30 PM	4:45 PM	Forum East
30	Sociology and Film/Television - Theory Mini-Conference	3:30 PM	4:45 PM	Forum West
31	W.E.B. Du Bois and His Legacy of Critical Research on Race	3:30 PM	4:45 PM	International Grand Ballroom
32	Poster Session	3:30 PM	4:45 PM	East
	Multi-Initiative Collaboration Between Sociology and Criminal Justice			
33	Programs	3:30 PM	4:45 PM	Jackson
34	50th Commemorative Panel II: Sociology, 50 Years Forward	3:30 PM	4:45 PM	Embassy East
	Innovative Approaches in Qualitative Research: New Horizons and			
35	Methods	5:00 PM	6:15 PM	Embassy East
36	Undergraduate Research II	5:00 PM	6:15 PM	International
	Southern Illinois University Carbondale Meet Up	6:30 PM	7:00 PM	Maxwell's Lounge
Friday, October 18				
	Small and Community Colleges Caucus Breakfast	7:30 AM	9:30 AM	Grand Ballroom East
	Breakfast	7:30 AM	9:30 AM	Grand Ballroom East
37	Environmental Crime/Harm and Justice Issues	8:00 AM	9:15 AM	Embassy East
38	Reproductive Justice in the Deep South	8:00 AM	9:15 AM	Embassy West
39	Undergraduate Research III	8:00 AM	9:15 AM	Forum East
	Social and Cultural Capital: Researching Access and Understanding			
40	Barriers	8:00 AM	9:15 AM	Forum West
41	Creating an Individualized Development Plan for Promotion and Tenure	8:00 AM	9:15 AM	International
	Outside the Box: New, Creative, or Innovative Approaches to Social			
42	Research	9:30 AM	10:45 AM	Embassy West
43	Undergraduate Research IV	9:30 AM	10:45 AM	Forum East
44	Media, Music, and Popular Culture	9:30 AM	10:45 AM	Forum West
45	Maintaining an Active Research Agenda at a Teaching Institution	9:30 AM	10:45 AM	Embassy East
46	Race, social media, and Politics	9:30 AM	10:45 AM	International
47	Homicide Studies	11:00 AM	12:15 PM	Embassy East
48	Sexuality, Gender, and Policy	11:00 AM	12:15 PM	Embassy West
49	Undergraduate Research V	11:00 AM	12:15 PM	Forum East
50	Author Meets Curious Readers: Gratuitous Angst in White America	11:00 AM	12:15 PM	Forum West
51	Experiential Learning: Using Monopoly to Teach about Social Justice	11:00 AM	12:15 PM	International
	Professional Headshots	11:00 AM	12:15 PM	Jackson Grand Ballroom
	Racial and Ethnic Minorities Caucus Luncheon	12:30 PM	1:30 PM	East

SCHEDULE AT A GLANCE

(All times Central Daylight Time)

#	Title	Start	End	Room
				Grand Ballroom
52	Plenary: Leading with Equity	2:00 PM	3:15 PM	West
53	Discrimination, Health and Mental Health	3:30 PM	4:45 PM	Embassy East
54	Looking Back: A History of Germantown in North Nashville	3:30 PM	4:45 PM	Forum East
55	50th Commemorative Panel III: Sociology, 50 Years Forward	3:30 PM	4:45 PM	Forum West
56	Let's Get Ready to Advance	3:30 PM	4:45 PM	Embassy West
	Undergraduate Networking Session (Limited complimentary snacks and beverages)	3:30 PM	4:45 PM	Grand Ballroom East
57	Organizing Your Workplace in a Right-to-Work State	3:30 PM	4:45 PM	International Grand Ballroom
	Remembering Departed MSSA Members	5:00 PM	5:30 PM	Central
	President's Closing Reception (Limited complimentary appetizers and beverages)	5:30 PM	6:30 PM	Crown Ballroom
	Business Meeting and Awards Banquet	6:30 PM	9:00 PM	Crown Ballroom
Saturday, October 19				
	Executive Council Meeting	8:30 AM	10:00 AM	Polk
	Theorizing U.S. Undergraduate Education: Boyer 2030 - Theory Mini-			
58	Conference	8:00 AM	9:15 AM	Virtual 4
59	Social Determinants of Health and Well-Being	9:30 AM	10:45 AM	Virtual 1
60	Student Perceptions of Satisfaction and Learning	9:30 AM	10:45 AM	Virtual 3
61	Teaching Survey Courses to Freshman and Sophomores	9:30 AM	10:45 AM	Virtual 2
62	Critical Social Theory and Politics - Theory Mini-Conference	9:30 AM	10:45 AM	Virtual 4
63	Undergraduate Research in Progress: Sociology of Deviance	9:30 AM	10:45 AM	Virtual 5
64	Leveraging Social Networks, Media, and Society	11:00 AM	12:15 PM	Virtual 1
65	Understanding Ethnicity and Gender Based Attitudes and Violence	11:00 AM	12:15 PM	Virtual 2
66	Gender, Sexuality, and Race	11:00 AM	12:15 PM	Virtual 3
	Critical Theory, Dialectic of Enlightenment, and Adorno's Sociology -			
67	Theory Mini-Conference	11:00 AM	12:15 PM	Virtual 4
68	Poster Session II	11:00 AM	12:15 PM	Virtual 5
69	Walking Tour of Historic Germantown	11:00 AM	12:30 PM	In Person
70	Disease, Disaster, and the Environment	2:00 PM	3:15 PM	Virtual 1
71	Sociology of the Profession	2:00 PM	3:15 PM	Virtual 2
	Theorizing the Apocalypse: Constructive Approaches to Crises - Theory			
72	Mini-Conference	2:00 PM	3:15 PM	Virtual 4
73	Teaching Health Professions Students	2:00 PM	3:15 PM	Virtual 3
74	Criminology and Criminal Justice	3:30 PM	4:45 PM	Virtual 1
75	Investigating Inequalities and Social Movements	3:30 PM	4:45 PM	Virtual 3
	Social Theory and History: Habermas' Legitimation Crisis after 50 Years			
76	- Theory Mini-Conference	3:30 PM	4:45 PM	Virtual 4



METROPOLITAN GOVERNMENT OF NASHVILLE AND DAVIDSON COUNTY



FREDDIE O'CONNELL
MAYOR

**A Letter of Welcome from
Mayor O'Connell**



Dear Friends,

On behalf of the Metropolitan Government of Nashville and Davidson County, I am honored to welcome you to 50th Annual Mid-South Sociological Association Conference.

If you have been to Nashville before, welcome back. If this is your first time here, I'm very excited for you. We're delighted you're visiting.

While you're here, I encourage you to explore the sights and sounds of Music City. I hope you discover the charm and hospitality that Nashville has to offer. Whether it is the bustling streets of downtown, the serene beauty of our parks and green spaces, our unique culinary culture, or our deep musical history, there truly is something for everyone to enjoy.

Have a great time connecting with each other and with our city. Pro tip: If you're trying our hot chicken for the first time, start with the mild.

All my best,

A handwritten signature in blue ink that reads "Freddie O'Connell".

Freddie O'Connell
Mayor, Metropolitan Government of Nashville and Davidson County

OFFICE OF THE MAYOR
METROPOLITAN COURTHOUSE • NASHVILLE, TENNESSEE 37201
PHONE: (615) 862-6000 • EMAIL: mayor@nashville.gov

WELCOME

FROM THE OFFICE OF THE PRESIDENT



Welcome to the 50th annual meeting of the Mid-South Sociological Association! I think I speak on behalf of the MSSA Board and the planning committee when I say we are so excited to be celebrating 50 years of this wonderful organization. As we gather this October, there are so many wonderful memories to look back on, and so much more to look forward to. The MSSA exists because a small group of sociologists desired to create an organization that was rigorous in its scientific inquiry and inclusive in its membership. The significance of equity and inclusion is at the heart of the MSSA.

In that light, I want to recognize Dr. Melencia Johnson, President-Elect and Program Chair, for coordinating an amazing conference centered on the theme, “Social Change & Resistance: Looking Back to Move Forward”. The conference will feature the special plenary speaker, Sharon Roberson, CEO of YWCA of Nashville & Middle Tennessee who leads the organization with a focus on racial and social justice. In addition to the special plenary, I hope you all attend the three commemorative panels that address, from a variety of disciplinary specialties, the trajectory of sociology moving forward. I also hope to see each of you at the special kick-off welcome session on Wednesday evening, the “In Memoriam” session Friday evening where we remember our friends and colleagues who have passed, and, as always, the awards banquet and dinner Friday night. Note that, in the spirit of being as inclusive as possible, we are holding virtual sessions on Saturday in support of those who prefer or need that mode of connection. So please stick around for those stimulating sessions! Last but not least, there will be a guided tour of historic Germantown on Saturday so please take advantage of this wonderful learning opportunity.

I’d like to close by thanking everyone who made this conference possible. It was a tremendous amount of collaboration and coordination that went into bringing this program to fruition. So, thanks again to Melencia Johnson (President-Elect), Jessica Pardee (Vice President), Giselle Greenidge (VP-Elect), Erin Rider (Secretary-Treasurer), and Meredith Huey Dye (Past President). In addition, our Committee Chairs have been invaluable. Thank you to Tina Deshotels (Membership), Jessica McCarty (Racial & Ethnic Minorities), Jessica Burke (Nominations), Matthew Schneider (the Profession), Matthew West (Small & Community Colleges), Andrea Hunt (Women, Gender, & Sexualities), and Marcus Brooks (Technology). Thanks also to Andrew Tatch for serving as Forum Editor and Kevin Breault for serving as Editor for *Sociological Spectrum*. A final thanks to anyone and everyone else who was involved in any way with making this 50th anniversary so meaningful and momentous.

I am humbled to be part of such an innovative, supportive, and inclusive organization. Here’s to the next 50 years!

Sincerely,

Theresa Davidson

Theresa Davidson, PhD
2024 President, MSSA
Samford University



WELCOME FROM THE OFFICE OF THE PRESIDENT-ELECT AND PROGRAM CHAIR



Welcome to the 50th Mid-South Sociological Association's Annual Conference and Meeting. First, I would like to thank all the session organizers, participants, officers, past officers, committee chairs, contributors, and all-around helpers for their time and talent in putting together a wonderful program. Without your dedication and hard work, this would not have been possible.

This year's theme, Social Change and Resistance: Looking Back to Move Forward was born out of the many ways we can compare and learn from the past and present to better inform our possible futures. Exploring the many ways at social change and resistance have presented over time using sociological and interdisciplinary approaches and spreading the knowledge gained to create a better populace is what we have been doing for the last 50 years and it is just what we need to push forward for another 50 years as an organization.

I walked into the doors of Brown Hall on the Campus of Norfolk State University in Norfolk, Virginia knowing that I wanted to be a sociologist. It was a conversation with a sociologist during my First Look that helped me make this decision. I soon learned that there was a storied history of sociology programs at Historically Black Colleges and Universities (HBCUs) and that sociologists like W.E.B. Du Bois, Ida B. Wells, and others pushed for Black America's understanding of their racialized and classed positions in our society. It was my time at Norfolk State that solidified my love for the study of society.

I left Norfolk State for the Southern Illinois University, Carbondale where I felt safe leaving home to be in the care of Dr. Thomas Calhoun. He served as my department chair and later a mentor as he transitioned from the department. He was also the first to compel me to attend MSSA in 2006 while he served as President. Now, 20 years later I will step into this role. I will be forever grateful for his leadership, mentorship, and encouragement to continue toward getting my PhD SIUC despite him having to move away to care for his family. I continued to attend MSSA upon graduating, reconnecting with fellow Salukis along the way. You will likely see us together in the hallways of this conference catching up like we do each year.

MSSA has been my professional "home" for about a decade, and I hope that you will make long lasting connections as you meet other students, faculty, practitioners, and observers this week. It is the most welcoming sociological conference that I have ever attended. It is a place where I know people, people know me, and I feel like I belong. I hope that you come back time and time again. We appreciate all that you do to propel the discipline forward.

Sincerely,

Melencia Johnson

Melencia Johnson, PhD
Associate Professor of Sociology
University of South Carolina Aiken

MSSA PAST PRESIDENTS

(Founded in 1975)

2022-2023	Meredith Dye, <i>Middle Tennessee State University</i>
2021-2022	Shelly McGrath, <i>University of Alabama, Birmingham</i>
2020-2021	Tina Deshotels, <i>Jacksonville State University</i>
2019-2020	Jessica Abbott, <i>Utah Tech University</i>
2018-2019	Jason Ulsperger, <i>Arkansas Technical University</i>
2017-2018	Ruth Chananie, <i>University of Northern Iowa</i>
2016-2017	Kevin Breault, <i>Middle Tennessee State University</i>
2015-2016	DeMond Miller, <i>Rowan University</i>
2014-2015	Anita Bledsoe-Gardner, <i>Johnson C. Smith University</i>
2013-2014	Timothy Gongaware, <i>University of Wisconsin-La Crosse</i>
2012-2013	Earl Wright II, <i>University of Cincinnati</i>
2011-2012	Mark Konty, <i>Public Scholar</i>
2010-2011	Roma Hanks, <i>University of South Alabama</i>
2009-2010	Ollie G. Christian, <i>Southern University</i>
2008-2009	Kimberly Ann Davies, <i>Augusta State University</i>
2007-2008	Keith F. Durkin, <i>Ohio Northern University</i>
2006-2007	Carl L. Bankston III, <i>Tulane University</i>
2005-2006	Thomas Calhoun, <i>Southern Illinois University Carbondale</i>
2004-2005	Duane A. Gill, <i>Mississippi State University</i>
2004	Frank Glamser, <i>University of Southern Mississippi</i>
2003-2004	Jackie Eller, <i>Middle Tennessee State University</i>
2002-2003	J. David Knottnerus, <i>Oklahoma State University</i>
2001-2002	Obie Clayton, <i>Morehouse College</i>
2000-2001	Peter L. Heller, <i>Middle Tennessee State University</i>
1999-2000	J. Kenneth Davidson, Jr., <i>University of Wisconsin-Eau Claire</i>
1998-1999	Lin Huff-Corzine, <i>University of Central Florida</i>
1997-1998	Dennis R. McSeveney, <i>University of New Orleans</i>
1996-1997	Thomas J. Durant, Jr., <i>Louisiana State University</i>
1995-1996	Craig J. Forsyth, <i>University of Louisiana - Lafayette</i>
1994-1995	J. Steven Picou, <i>University of South Alabama</i>
1993-1994	Stanford M. Lyman, <i>Florida Atlantic University</i>
1992-1993	Arthur G. Cosby, <i>Mississippi State University</i>
1991-1992	Joy B. Reeves, <i>Stephen F. Austin State University</i>
1990-1991	Donna K. Darden, <i>Tennessee Technological University</i>
1989-1990	C. Eddie Palmer, <i>University of Louisiana - Lafayette</i>
1988-1989	William Kenkel, <i>University of Kentucky</i>
1987-1988	James K. Skipper, Jr., <i>University of North Carolina - Greensboro</i>
1986-1987	Willie Pearson, Jr., <i>Wake Forest University</i>
1985-1986	Dennis L. Peck, <i>The University of Alabama</i>
1984-1985	Marsha McGee, <i>Northeast Louisiana University</i>
1983-1984	Donald R. South, <i>University of South Alabama</i>
1982-1983	Gene Acuff, <i>Oklahoma State University</i>
1981-1982	Clifton D. Bryant, <i>Virginia Polytechnic Institute & State University</i>
1980-1981	Jerome J. Salomone, <i>University of New Orleans</i>
1979-1980	Samuel E. Wallace, <i>University of Tennessee - Knoxville</i>
1978-1979	H. Paul Chalfant, <i>Texas Tech University</i>
1977-1978	Alvin L. Bertrand, <i>Louisiana State University</i>
1976-1977	Donald E. Allen, <i>Oklahoma State University</i>
1975-1976	Julian B. Roebuck, <i>Mississippi State University</i>

2024 MID-SOUTH SOCIOLOGICAL ASSOCIATION BOARD MEMBERS

EXECUTIVE OFFICERS

Past President:	Meredith Huey Dye, <i>Middle Tennessee State University</i>
President:	Theresa Davidson, <i>Samford University</i>
President-Elect and Program Chair:	Melencia Johnson, <i>University of South Carolina Aiken</i>
Vice President:	Jessica Pardee, <i>Rochester Institute of Technology</i>
Vice President-Elect:	Giselle Greenidge, <i>Northwest Missouri State University</i>
Secretary-Treasurer:	Erin Rider, <i>Nevada State University</i>
Parliamentarian	DeMond Miller, <i>Rowan University</i>

COMMITTEE CHAIRS

Committee on Membership:	Tina Deshotels, <i>Jacksonville State University</i>
Committee on Racial and Ethnic Minorities:	Jessica McCarthy, <i>South Alabama University</i>
Committee on Nominations:	Jessica L. Burke, <i>Francis Marion University</i>
Committee on the Profession:	Matthew Schneider, <i>University of North Carolina Wilmington</i>
Committee on Small & Community Colleges:	Matthew West, <i>Lawson State Community College</i>
Committee on Women, Gender & Sexualities:	Andrea Hunt, <i>University of North Alabama</i>
Technology Committee Chair	Marcus Brooks, <i>Western Kentucky University</i>

PUBLICATION EDITORS

<i>Sociological Spectrum</i> Editor and Archivist:	Kevin Breault, <i>Middle Tennessee State University</i>
MSSA Forum Editor:	Andrew Tatch, <i>Troy University</i>

AD-HOC COMMITTEES AND EX-OFFICIO OFFICERS

Stanford Lyman Memorial Scholarship:	Raymond Barranco, <i>Mississippi State University</i>
Stanford Lyman Book Award:	James Gadberry, <i>Athens State University</i>
Dr. Thomas Calhoun Mentoring Award	Earl Wright, II, <i>Rhodes College</i>
Technology and Digital Presence Manager:	Marcus Brooks, <i>Western Kentucky University</i>
MSSA Listserv:	Ruth Chananie, <i>University of Tampa</i>

PLENARY SPEAKER SPOTLIGHT



Sharon K. Roberson, Esq. | President & CEO YWCA Nashville & Middle Tennessee

Sharon K. Roberson, Esq. is a seasoned C – Suite executive with over 30 years of experience in the insurance industry. She serves as President and CEO of YWCA Nashville & Middle Tennessee, the largest domestic violence services provider in Tennessee. Since joining the YWCA, Sharon has increased the 65-bed Weaver Domestic Violence Center's capacity by 15 beds. She has also broadened the agency's life-saving services, including adding the only Emergency DV Text Line in Tennessee and implementing a children's program at Weaver Center. In 2021, YWCA opened the first-ever, state-of-the-art pet shelter in Tennessee for pets of domestic violence victims.

Under Sharon's leadership, the YWCA has more than tripled its school-based programs, including expanding the AMEND Together healthy masculinity program to eight other YWCA associations across the country. During COVID, the YWCA expanded its adult learning center programming and career services.

Sharon has renewed the YWCA's focus on racial justice by implementing a Social Justice and Advocacy program. Several anti-domestic violence pieces of legislation championed by YWCA have become law in Tennessee under her leadership. During Sharon's tenure, the YWCA in Nashville received the largest single donation in its 125-year history.

Sharon has received community recognition, including being a two-time Athena nominee, Nashville Bar Fellow, Leadership Nashville alum, Nashville Business Journal Women of Influence, and being inducted into the YWCA Academy for Women of Achievement. Sharon has been named one of Nashville's Most Powerful Women by the Nashville Post and five times one of Nashville's Most Admired CEOs by the Nashville Business Journal. In 2022 she received the prestigious Napier-Looby Bar Foundation Z. Alexander Looby Lifetime Achievement Award.

Under Sharon's leadership, the YWCA was named a 2018 person of the year by the Nashville Tennessean and one of Nashville's 24 Black Leaders to Know in 2024 by the publication. She serves on the Children's Hospital at TriStar Centennial Community Advisory Board and the Regions Bank Advisory Board.

Sharon graduated from Vanderbilt University with a B.A. in Economics and a law degree.

**eliminating racism
empowering women**
ywca
Nashville & Middle Tennessee

Join us for an Author Meets Curious Readers panel, Friday 11:00-12:15
(Forum West), followed by a book signing by Deena Isom.

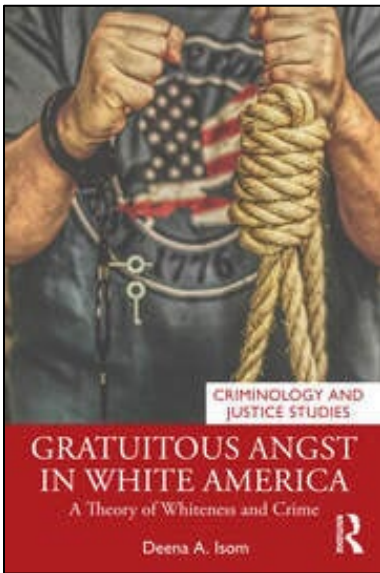

1st Edition

Gratuitous Angst in White America: A Theory of Whiteness and Crime

By [Deena A. Isom](#) Copyright 2024

Paperback 9780367763992

List: \$48.95

Hardback 9780367766436

List: \$170.00

e-Book 9781003167877

List: \$48.95

182 Pages 5 B/W Illustrations

December 19, 2023 by Routledge

Gratuitous Angst in White America presents a new criminological theory that explains the racialized experiences of white people. Unlike orthodox traditions that assume whiteness as normative or progressive traditions that center the experiences of the marginalized and oppressed, the theory of whiteness and crime flips those perspectives and turns a lens toward white people's lived experiences and the ideologies of whiteness. The theory of whiteness and crime answers two overarching questions: *How does being white impact one's likelihood of engaging in deviant, criminal, and/or violent behaviors?* And, *why are white people treated differently than other racial and ethnic groups by the criminal legal system?* Through the application of a critical whiteness perspective to criminology, the theory of whiteness and crime is an intersectional and integrated framework that explains within (and between) group differences in negative behaviors and entanglements with the criminal legal system.

FRIENDS OF THE MSSA

Consider becoming a Friend of the MSSA today! I am inviting you to participate in future conferences by becoming a "Friend of MSSA." As a "Friend of MSSA," your department, research institute, center, research collective or civic organization has several opportunities to make conference participants aware of your activities.

For a one-time fee of \$500 you will receive:

- Receipt of a plaque and letter from the MSSA President recognizing your achievement
- Half off your next year's membership
- Upon completion of payment, the opportunity to donate \$200 of your total membership payment to a specific MSSA effort (e.g., MSSA General Fund; MSSA Minority Fund; Sponsored Undergraduates; and Stanford Lyman Scholarship Fund)

SPECIAL THANKS TO OUR LIFETIME MEMBERS

Platinum Members Bronze Members

Ollie Christian	Jessica Abbott
Kevin Breault	Ruth Chananie
DeMond Miller	Tina Deshotels
Jason Ulsperger	Jessica Pardee
Willie Pearson	

Interested in becoming a lifetime member? You may do so at anytime at www.midsouthsoc.org.

Lifetime members enjoy the following benefits:

Receipt of a plaque and letter from the MSSA President recognizing your achievement. No yearly membership fee payment. Reserved seating at the annual dinner/banquet. Special recognition in the annual printed program.

IN MEMORIAM

Let us take time to remember the members we have lost over the last 50 years. Their contributions, mentorship, and presence have left an indelible mark on our lives and communities. As we gather on Friday, let us share stories that celebrate their achievements, recount moments that made us smile, and cherish the lessons they imparted. Through our memories, they continue to light our path and inspire us to live fully and meaningfully. In honoring them, their research and pedagogy, we not only pay tribute to their lives but also strengthen the bonds that unite us, reminding us of the importance of connection, compassion, and legacy.

Jackie Eller (2023)

Hugh Floyd (2023)

Julian Roebuck (2023)

Marc Riedel (2019)

Tom Calhoun (2019)

Marc Matre (2018)

Alpha Morris (2014)

Harry J. Hale Jr. (2011)

Clifton Bryant (2010)

Alvin Bertrand (2006)



**SPECIAL THANKS TO THE GENEROUS DONORS TO THE
\$50 FOR 50 YEARS CAPITAL CAMPAIGN**

Jessica Abbott	Tina Deshotels	DeMond Miller
Anita Bledsoe-Gardner	Meredith Dye	Jessica Pardee
Kevin Breault	Roma Hanks	Erin Rider
Ollie Christian	Melencia Johnson	Jason Ulsperger
Katie Cooper	Thomas Kersen	Earl Wright, II
Theresa Davidson	Several Anonymous Donors	Dennis McSeveney
		In memory of Hugh Floyd

There's still time to donate. The campaign will continue through the end of this program year. Visit our online portal from www.midsouthsoc.org.

**SPECIAL THANKS TO OUR PAST PRESIDENTS FOR THEIR GENEROUS
CONTRIBUTIONS TO THE PRESIDENTIAL RECEPTIONS**

Meredith Dye
Tina Deshotels
DeMond Miller
Willie Pearson

SPECIAL THANKS TO OUR INSTITUTIONAL MEMBER

Rowan University

SPECIAL THANKS TO OUR DEPARTMENTAL MEMBER

Samford University



A NOTE TO MEMBERS AFFECTED BY HURRICANES HELENE AND MILTON

Several of our member states have been severely affected by Hurricane Helene and Milton, and our hearts go out to you during this incredibly challenging time. We are deeply concerned about your safety and well-being as you begin the lengthy process of recovery.

As we convene here in the relative safety of Nashville, TN, where we will address various sociological topics, it is impossible to overlook the shadows cast by Helene and Milton. Many of us are grappling with the aftermath and the emotional toll it has taken on our families and communities. While we aim to focus on resilience, we acknowledge the work still ahead for so many.

Please know that you and your loved ones are in our thoughts, and we hope for your strength and healing in the days to come.

In solidarity,

2024 MSSA Program Committee



Department of Society, Culture,
Crime, & Justice Studies

SOCIOLOGY • CRIMINOLOGY • ANTHROPOLOGY • FOLKLORE

Western Kentucky University's (WKU) Department of Society, Culture, Crime, & Justice Studies invites applications for an Assistant Professor position. This is a full-time, nine-month, tenure-track eligible position to begin August 15, 2025.

Applicants should have a Ph.D. in Sociology, Criminology, or Criminal Justice completed by the time of appointment. The primary expectation for the position is the delivery of high-quality instruction of elective and core requirements supporting the undergraduate program in Criminology. Primary area of specialization is Juvenile Delinquency. Ability to deliver both face-to-face and online instruction is required. Demonstrated excellence in teaching and an ongoing record of scholarly research are essential. Involvement in service activities is an expectation of the position once selected.

Apply at:

<https://wku.interviewexchange.com/jobofferdetails.jsp?JOBID=181790> or
using the QR code.



2024 MSSA CONFERENCE PROGRAM

WEDNESDAY, OCTOBER 16, 2024

1:00pm – 6:30pm	MSSA Registration	Promenade
1:00pm – 2:00pm	Executive Council Meeting	Polk (2 nd Floor)

1. Crime and Criminology- Challenges to Reentry for Incarcerated Persons [Regular Paper Session] Wednesday | 2:00 pm-3:15 pm | Embassy East

Organizer: David C. May, Mississippi State University

Chair: David C. May, Mississippi State University

- *Evaluating The Effectiveness of a Substance Abuse Education Program Among Incarcerated Individuals in Mississippi.*Chandleigh Barton, Mississippi State University, Catherine Rene` Authement, Mississippi State University, Angela Robertson, Mississippi State University, Stacy Haynes, Mississippi State University, David C. May, Mississippi State University
- *Did Thinking for a Change Really Change My Thinking?.*Adeline Barrett, Mississippi State University, Catherine Rene` Authement, Mississippi State University, Stacy Haynes, Mississippi State University, David C. May, Mississippi State University
- *When I Get Out of Here, I'll Still Be Doing Time: Perceptions of Incarcerated Fathers about Financial Penalties in Criminal Justice.*Michayla Mack, Mississippi State University, Stacy Haynes, Mississippi State University, Sanna King, Mississippi State University, David C. May, Mississippi State University
- *The Impact of Childhood Trauma on Unhealthy Behaviors Among Correctional Officers in Mississippi.*Julie Stepp, Mississippi State University, Stacy Haynes, Mississippi State University, David C. May, Mississippi State University

2. Undergraduate Research I [Regular Paper Session] Wednesday | 2:00 pm-3:15 pm | Embassy West

Chair: Giselle Greenidge, Northwest Missouri State University

- *The Souls of Black Folk: A Comparative Historical Analysis of the Harlem Renaissance and Modern Art Movements.*Symone Micah Gaskin, Kennesaw State University
- *Exploring Theoretical Explanations for Race, Racism, and Punitive Attitudes toward Crime.*Colton Rodano, University of Montevallo, Chris Bounds, University of Montevallo
- *Historical Context of the Federal Writers Project NC Born in Slavery Narratives.*Jenna Catherine Humble, University of North Carolina- Pembroke
- *The Relationship Between Restrictive Voting Laws, Social and Political Contexts, and Voter Turnout.*Sania Williams, Fisk University, Meagan Rainock, Fisk University

3. Digital Sociology [Regular Paper Session] Wednesday | 2:00 pm-3:15 pm | International

Organizer: Rachel E. Davis, Middle Tennessee State University

Chair: Eryn Gruzca Viscarra, Georgia College

- *Consumer Trust Under Siege: The Rise and Impact of Fake Reviews in the Digital Marketplace.*[Tina Deshotels, Jacksonville State University](#), [Craig J. Forsyth, University of Louisiana-Lafayette](#)
- *Unpacking Family Fun: A Sociological Exploration of Bonding and Making Memories.*[Julie Mikles-Schluterman, Arkansas Tech University](#)
- *Culture Jamming: A Media Literacy Activity.*[Eryn Gruzca Viscarra, Georgia College](#)

4. Socio-political Contexts: Race, Class, Gender and Deviance [Regular Paper Session]

Wednesday | 3:30 pm-4:45 pm | Embassy West

Organizer: Rachel E. Davis, Middle Tennessee State University

Chair: Rachel E. Davis, Middle Tennessee State University

- *She Who Must Not Be Scammed: Transphobes, Trolls, and Tricksters in Online Research.*[Brianna Turgeon, Jacksonville State University](#), [Sarah Beth Donley, Jacksonville State University](#)
- *Racism, Antiracism, and Other Values.*[Peter John Shrock, Southeastern Louisiana University](#), [John Boulahanis, Southeastern Louisiana University](#)
- *Gender in Emerging Adulthood: Perceptions and Experiences of Masculinity and Femininity in Oklahoma.*[Afra Sayara Rahman, Oklahoma State University](#), [Rebecca Rose Alberty, Oklahoma State University](#), [Heather McLaughlin, Oklahoma State University](#)
- *Black Bisexual Men's Intersectional Stigma Experiences.*[Opal Gay, Georgia State University](#), [Angela-Faith Thomas, Georgia State University](#)

5. 50th Commemorative Panel I: Sociology, 50 Years Forward [Panel]

Wednesday | 3:30 pm-4:45 pm | Embassy East

Chair: Shelly McGrath, University of Alabama at Birmingham

Panelists:

- Tina Deshotels, Jacksonville State University
- Vanessa Greenslade, Southern University
- Melanie Anne Escue, University of North Carolina at Pembroke
- Joel Crombez, Kennesaw State University

6. Applying to Ph.D. and MA programs - Sponsored by the Committee on Professions [Panel]

Wednesday | 3:30 pm-4:45 pm | International

Chair: Kailee E.D. Lancaster, University of North Carolina Wilmington

This Q&A Panel, sponsored by the Committee on the Profession, provides a space for undergraduate and master's level students to learn about the graduate school application process. Emphasis will be placed on sociology programs. Representatives of both master's programs and Ph.D. programs will serve on the panel. Each panelist will discuss what the application process looks like in their programs

before answering a series of frequently asked questions, including questions about funding/assistantships, application materials, and deciding where to apply. Significant time will be dedicated to answering audience questions.

Panelists:

- Vicky M. MacLean, Middle Tennessee State University
- Lawrence Stacey, Vanderbilt University
- Marcus Brooks, Western Kentucky University

Professional Headshots

Wednesday | 3:30 pm-4:45 pm | Far Promenade

Need a professional headshot? Drop by and have your photo taken. Photos will be delivered via share drive after the conference.

Welcome Reception: 50th Anniversary Kick-Off

Wednesday | 5:00 pm-6:30 pm | Grand Ballroom Central

Join us for special recognition of our past presidents. All registered attendees are invited. A limited number of drink tickets available on a first-come basis.

THURSDAY, OCTOBER 17, 2024

Breakfast

Thursday | 7:30 am-9:30 am | Grand Ballroom East

Available for registered MSSA conference participants.

Registration

Thursday | 8:00 am-5:00 pm | Promenade

Quiet Room

Thursday | 8:00 am-5:00 pm | Johnson

This room is open as a quiet space to work on projects or step away from the noise of the conference.

Sociological Theory Caucus Breakfast - Theory Mini Conference

Thursday | 8:00 am-8:30 am | Grand Ballroom East

Organizer: Harry F. Dahms, University of Tennessee - Knoxville

Chair: Anthony J. Knowles, University of Tennessee-Knoxville

Join members of the sociological theory caucus for breakfast. Open to registered MSSA conference attendees.

7. Vaxxers, Preppers, and Immunizers: Where is the dis"pair"ity? [Regular Paper Session]

Thursday | 8:00 am-9:15 am | Embassy East

Organizer: Neil Robert White, University of Louisiana Monroe

Chair: Neil Robert White, University of Louisiana Monroe

- *College students beliefs concerning if "flu shots cause the flu", flu shot behaviors, and perceptions concerning if the state should be preparing people for a flu pandemic.. ..*[Neil Robert White, University of Louisiana Monroe](#), Thomas Michael Kersen, Jackson State University
- *The Spanish Flu and its Effects on Population Growth: The Aftermath.*[Jessica Lynn Burke, Francis Marion University](#), Lisa A. Eargle, Francis Marion University, Ashraf Esmail, Dillard University
- *The Pandemic Did Not Happen: Interpreting COVID-19 Through Baudrillard's Simulacra and Simulation.*[John McCollum, Alabama A and M University](#)

8. Death, Dying, and Disease Studies [Regular Paper Session]

Thursday | 8:00 am-9:15 am | Embassy West

Chair: Jason Shawn Ulsperger, Arkansas Tech University

- *"The Youngest in the Room": Embodied Aberration for Young Adults in Cancer Treatment Spaces.*[Kathryn Norton-Smith, University of Arkansas](#)
- *Addressing Health Equity in Marginalized Populations in Life Course Perspective: A Comprehensive Review and Future Directions for Research and Action.*Nancy Kelley, University of South Alabama, Hosik Min, University of Texas - Tyler, Ashley Williams, University of South Alabama, [Roma Hanks, University of South Alabama](#)
- *"Death Bouncers" and "Spiritual Guides": How End-of-Life Doulas Provide, Frame, and Navigate Spirituality and Spiritual Care.*[Sarah Beth Donley, Jacksonville State University](#), Casey Fannin, Jacksonville State University

9. Potpourri: Immigration, Environment, Drug Use [Regular Paper Session]

Thursday | 8:00 am-9:15 am | Forum West

Chair: Erin L Rider, Nevada State University

- *Environmental Volunteering as a Gateway to Environmental Justice Frameworks? An exploratory case study of volunteer water monitors in Coastal Carolina.*[Matthew Jerome Schneider, University of North Carolina Wilmington](#)
- *Faith-Based Organizations' Navigation of External and Internal Regulations and Resources in Providing Humanitarian Resettlement Opportunities to Refugees.*[Erin L Rider, Nevada State University](#)
- *Correlates of Psilocybin Use Among Emerging Adults in the United States.*[Lauren Norman, University of North Carolina Pembroke](#)

10. Arts In Movement: Courageous 8 [Panel]

Thursday | 8:00 am-9:15 am | Forum East

Organizer: Jessica Barker, Alabama Association for the Arts, Inc

Chair: Jessica Barker, Alabama Association for the Arts, Inc

An arts exhibition and speaker series centered on the intersectionality of history, civics, art, and culture to include the examination of various art forms and their impacts on the movement for civil rights and social justice. Through partnership, AL Association for the Arts, National Education and Empowerment Coalition, and Friends of Selma to Montgomery National Historic Trails will manage the Southern Tour of the traveling exhibition based on Selma's voting rights activists, known by historians as the "Courageous Eight." These famous "Eight" were Rev. F.D. Reese, Ulysses Blackmon, Amelia Boynton-Robinson, Ernest Doyle, Marie Foster, James Gildersleeve, Rev. J.D. Hunter and Rev. Henry Shannon. These unsung heroes didn't get the same notoriety or name recognition as other historic figures, but they were instrumental in the fight for equal rights for African-Americans. Their stories of sacrifices and efforts during the Civil Rights Movement are now preserved in an artistic traveling exhibit that bears its name. Accompanying the charcoal art exhibit, panelists will speak to the lives of these figures and how they powered the movement to cross the bridge, sparking the Bloody Sunday massacre, in efforts to champion for and successfully advance the Voting Rights Act of 1965.

Panelists:

- Keith Parker, National Education and Empowerment Coalition, Inc.
- Althestien Johnson, Friends of the Selma to Montgomery National Historic Trails

Quiet Room

Thursday | 8:00 am-5:00 pm | Johnson

This room is open as a quiet space to work on projects or step away from the noise of the conference.

Registration

Thursday | 8:00 am-5:00 pm | Promenade

11. Politics, Social Movements, and Social Change [Regular Paper Session]

Thursday | 9:30 am-10:45 am | Embassy East

Organizer: Ruth Chananie, University of Tampa

Chair: Ruth Chananie, University of Tampa

- *From Civil Rights to Armed Resistance to Community Empowerment: The Rise and Fall of the Black Panther Party.Andrew Wayne Austin, University of Wisconsin-Green Bay*
- *Child of Courage: The Life and Legacy of Ruby Bridges.Keith Parker, National Education and Empowerment Coalition, Inc.*
- *Liberty House.Thomas Michael Kersen, Jackson State University*

12. Navigating the Dynamic Landscape of Social Interaction in the Digital Age [Regular Paper Session]

Thursday | 9:30 am-10:45 am | Embassy West

Organizer: Monica Bixby Radu, Southeast Missouri State University

Chair: Rachel E. Davis, Middle Tennessee State University

- *Digital Sovereignty, Material Atrocities: Social Media Corporations as State Criminal Actors.*[Rachel E. Davis, Middle Tennessee State University](#)
- *Webkinz & the Genesis of Digital Selfhood.*[Jennifer Nicholas, Georgia Tech](#)
- *The Family in the Age of AI-Chat bots: Implications for Policy.*[Julietta Raymond, Southern University and A&M College](#)

13. Critical Sociology and the Politics of Fear - Theory Mini-Conference [Regular Paper Session]
Thursday | 9:30 am-10:45 am | Forum West

Organizer: Harry F. Dahms, University of Tennessee - Knoxville

Chair: Joel Crombez, Kennesaw State University

- *An Explicit Sociology of Fear and Anxiety.*[Joel Crombez, Kennesaw State University](#), Chasidy Harris, University of Tennessee-Knoxville
- *Whiteness in Control: Power Mechanisms in U.S. Refugee Policy Through the Lens of Foucault and Critical Race Theory.*[Sarah Castillo, University of Tennessee](#)
- *Cur Country: The Role of the "Dangerous Dog" in American Society.*[Jeremy Smith, University of Tennessee-Knoxville](#)

14. Teaching Sociology and Criminology [Regular Paper Session]
Thursday | 9:30 am-10:45 am | International

Organizer: Matthew West, Lawson State Community College

Chair: Matthew West, Lawson State Community College

- *Engaging Students in Criminology: Qualitative Results from a Photographic Assignment.*[Brett Lehman, Auburn University at Montgomery](#), Amanda Heitkamp, Troy University
- *Integrating Sociology and Philosophy in Justice Studies.*[Justin Smith, Western Kentucky University](#)
- *Grad School Glow-Up: Success Strategies of the SS-6690 Seminar Course.*[Jolene Vincent, Troy University](#)
- *What's Wrong With Gen-Z?!? Exploring Claims About Generational Differences Using The General Social Survey in Statistics Courses.*[Andrew James Tatch, Troy University](#), Noelle Kemper, Troy University, Thomas Pohlmeier, Troy University

15. Crime and Criminology- White Collar Crime and Ethical Use of Private Data [Regular Paper Session]

Thursday | 11:00 am-12:15 pm | Embassy East

Organizer: David C. May, Mississippi State University

Chair: David C. May, Mississippi State University

- *The Promise and Peril of Using Surveillance Economy Data for Public Research.*[Barton Moffatt, Mississippi State University](#), [Emma Biddles, Mississippi State University](#), [David C. May, Mississippi State University](#), [Mike Potter, Mississippi State University](#)

- *Understanding Why People Act Ethically in Using Public Data.*[David C. May, Mississippi State University](#), Emma Biddles, Mississippi State University, Mike Potter, Mississippi State University, Barton Moffatt, Mississippi State University, Clay Hardwick, Mississippi State University, Timothy McClure, University of South Carolina Aiken
- *Community Structure and White-Collar Crimes: Testing Social Disorganization Theory.*[David Oluwashina Ademule, Mississippi State University](#)

16. Environment and Society [Regular Paper Session]

Thursday | 11:00 am-12:15 pm | Embassy West

Organizer: Angela Mertig, Middle Tennessee State University

Chair: Angela Mertig, Middle Tennessee State University

- *Racial/Ethnic Residential Segregation and Health Inequalities in North Carolina Rural-Urban Neighborhoods.*[Melanie Anne Escue, University of North Carolina at Pembroke](#), Kai Anderson, University of North Carolina-Pembroke, Kristen Stowell, University of North Carolina-Pembroke, J. Porter Lillis, University of North Carolina-Pembroke, Shaohu Zhang, University of North Carolina-Pembroke
- *Resource Exploitation, Pollution, and Quality of Life in Developing Nations..*[Jessica Lynn Burke, Francis Marion University](#), Lisa A. Eargle, Francis Marion University, Ashraf Esmail, Dillard University

17. Navigating Tenure and Promotion in Academia [Roundtable]

Thursday | 11:00 am-12:15 pm | International

Organizer: Giselle Greenidge, Northwest Missouri State University

This roundtable is designed to provide faculty, specifically Assistant Professors and Associate Professors strategies and tips for navigating promotion from Assistant to Associate Professor, and from Associate to Professor. Attendees will also learn about the tenure process and how to negotiate benefits including salary. This session may be beneficial to Black scholars.

Discussants:

- Giselle Greenidge, Northwest Missouri State University
- Melencia Johnson, University of South Carolina Aiken
- Erin L Rider, Nevada State University

18. Gender and Sexualities Roundtable [Roundtable]

Thursday | 11:00 am-12:15 pm | Polk

Chair: Natalie Blanton, University of Tennessee at Chattanooga

- *Biphobia within in the Queer Community..*[Matine Haizlp, Middle Tennessee State University](#)
- *Disability, Sex Education & The Denial of Pleasure.*[Mikael Emmett Nelson, The University of Tennessee at Chattanooga](#), Natalie Blanton, University of Tennessee at Chattanooga
- *Abortion Policy and Bodily Autonomy in State Legislation.*[Kelsey Johnson, Middle Tennessee State University](#)

19. Building on Du Bois' Sociological Approach to Address Health Disparities at the Neighborhood Level [Panel]

Thursday | 11:00 am-12:15 pm | Forum East

Organizer: Nancy Seay, Simmons College of Kentucky

Chair: Nancy Seay, Simmons College of Kentucky

W.E.B. DuBois' seminal neighborhood study, *The Philadelphia Negro: A Social Study*, challenged the prevailing narrative identifying race as the cause of health disparities. DuBois resisted this false narrative by employing meticulous methodology to demonstrate how multilevel environmental factors surrounding the Black residents of Philadelphia's Seventh Ward, rather than inward and genetically acquired characteristics, determined health differences between Black and White Philadelphians. We reflect on DuBois' neighborhood research as we also resist prevailing narratives connecting social and individual characteristics to the health outcomes in neighborhood contexts. Inspired by the concept of the Universal Basic Income, we introduce the Universal Basic Neighborhood (UBN) to suggest that instead of diagnosing and treating individuals (only) that we need to diagnose and write prescriptions for whole communities to decrease health disparities swiftly and significantly. Our panel will discuss the UBN concept and associated fieldwork comparing our community-based participatory action research and resource-based approach, to methodological approaches used early on by DuBois.

Panelists:

- Nancy Seay, Simmons College of Kentucky
- Jecorey Arthur, Simmons College of Kentucky
- Joel Goza, Simmons College of Kentucky
- Camara Douglas, Simmons College of Kentucky
- Patricia Reeves, University of Louisville

Discussant: Michael Emerson, Rice University;

Professional Headshots

Thursday | 11:00 am-12:15 pm | Far Promenade

Need a professional headshot? Drop by and have your photo taken. Photos will be delivered via share drive after the conference.

20. Education as Empowerment: How can we support immigrant students? [Regular Paper Session]

Thursday | 12:30 pm-1:30 pm | International

Organizer: Phattra Marbang, University of Georgia

Chair: Sarah Castillo, University of Tennessee

- *Education as Empowerment: Supporting Immigrant Students in a Hispanic-Serving Institution.[Angela Vergara, University of Central Florida](#)*
- *Difficulties faced by female international students with dependent children.[Farah Tasneem, University of Georgia](#)*
- *Regulating and Disciplining International Students' Bodies: The Mechanics of "Othering" in the United States.[Phattra Marbang, University of Georgia](#)*

Women, Gender, and Sexualities Caucus Luncheon
Thursday | 12:30 pm-1:30 pm | Grand Ballroom East

Organizer: Andrea Nicole Hunt, University of North Alabama

A time for women, gender, and sexualities researchers and members of historically marginalized genders and sexualities to gather. A limited number of lunches will be provided for registered MSSA Conference attendees.

21. Media, Politics, and Inequality [Regular Paper Session]
Thursday | 2:00 pm-3:15 pm | Forum East

Organizer: Marcus Brooks, Western Kentucky University

Chair: Jiabin Fan, University of Arkansas at Little Rock

- *"From Androgyny to Binary and Back: A Content Analysis on Nonbinary TikToks".*[Vannah Hatton, University of Louisville](#)
- *Fabricated testimonials: White savior narratives and a new lens of observation.*[Elliott Howard, University of Tennessee-Knoxville](#)
- *Is There Only White Christian Nationalism? An Analysis of the Black Christian Right on TikTok..*[Marcus Brooks, Western Kentucky University](#)
- *"Not French enough"? Aya Nakamura and the Paris Olympics. Debates, controversies, backlash, and misogynoir..*[Marie des Neiges Leonard, The University of South Alabama](#)
- *Understanding the Sexualization and Objectification of Gender in Print Advertisements Over Time: An Intersectional Approach.*[Susan McClain, University of Arkansas at Little Rock, Jiabin Fan, University of Arkansas at Little Rock](#)

22. Sociological Theory: Fine Arts, Objects, and Social Breakdown - Theory Mini-Conference [Regular Paper Session]

Thursday | 2:00 pm-3:15 pm | Forum West

Organizer: Harry F. Dahms, University of Tennessee - Knoxville

Chairs: Harry F. Dahms, University of Tennessee - Knoxville; Laura Hart, Missouri State University;

- *Deepening Students' Understanding of Sociological Theory through Fine Visual Arts.*[Laura Hart, Missouri State University](#)
- *Fantasy Production and Risk.*[Jeremy A Ross, Jacksonville State University, Joshua Coheely, Jacksonville State University](#)
- *Object Placement Theory.*[Kiya Rayne Simmons, UT Martin](#)
- *Social Breakdown: Structural Ritualization Theory, the DDR Model, and Therapeutic Possibilities.*[Jason Shawn Ulsperger, Arkansas Tech University, Kristen Ulsperger, Arkansas Tech University](#)

23. AI, Scholarship, and Teaching: Creative Tools for Learning and Teaching [Roundtable]
Thursday | 2:00 pm-3:15 pm | Jackson

Organizer: Kimberly Michelle Murray, Texas A&M University Texarkana

- *Student Survey Data about AI at a Southern Regional University.*[Kimberly Michelle Murray, Texas A&M University Texarkana](#), Sara Lawrence, Texas A&M University - Texarkana, Joe Burzynski, Texas A&M University - Texarkana

24. Criminology Research in Progress [Roundtable]

Thursday | 2:00 pm-3:15 pm | Polk

Chair: Shara Anansa Mintz, Norfolk State University

- *State-Level Retention of the Death Penalty: Factors Driving Continued Use in the U.S.*[Shara Anansa Mintz, Norfolk State University](#)
- *Do Children Feel Safe at School?.*[Vaun Baltimore, Middle Tennessee State University](#)

25. Research Methods in the Current Era of COVID-19 [Panel]

Thursday | 2:00 pm-3:15 pm | Embassy East

Organizer: Lain A.B. Mathers, Indiana State University

Chair: Lain A.B. Mathers, Indiana State University

The COVID-19 pandemic posed challenges to the ways many sociologists gather data. In Spring 2020, scholars were having to shift course in their research endeavors, and quickly, as new public health information became available. There were regular conversations among sociologists about how to adapt to these changes when we knew little about COVID-19, how it spread, and the broader impacts of this illness on our social life. Four years later, many COVID-19 precautions and discussions have fallen to the wayside. Indeed, some even go so far as to suggest that the pandemic is over, despite data that reveals that COVID-19 is still a prevalent virus impacting thousands of individuals. However, there has been relatively little discussion about how our research is continually impacted by COVID-19 in the later stages of the pandemic. This panel discussion will bring together scholars using multiple research methods to discuss how their work is shaped by the present moment we are in vis-à-vis the COVID-19 pandemic. How might recruiting survey respondents be shaped by anti-science discourses that became more prevalent in the wake of early COVID-19? How do ethnographers who continue to wear masks in public blend into settings where most people don't anymore? In short: the focus of this panel will be: How are our decisions about what we research, and how we do our research, shaped by the lingering impacts of COVID-19?

Panelists:

- Nik Lampe, University of South Florida
 - Lisa Miller, Eckerd College
 - J. Sumerau, University of Tampa
 - Katie Cooper, University of Tampa
- Discussant: Lain A.B. Mathers, Indiana State University;

26. Black Women's Resistance through Persistence [Panel]

Thursday | 2:00 pm-3:15 pm | Embassy West

Organizer: Melencia Johnson, University of South Carolina Aiken

Chair: Giselle Greenidge, Northwest Missouri State University

Resistance comes in many forms. This interdisciplinary panel will discuss paths of personal resistance to micro-politics and institutional pressure to conform and exit their chosen field. Their inspiring stories of how persistence in their disciplines has led to rewarding careers in and out of academia will be beneficial to students and faculty alike. In discussing their current projects, panelists will hone in on the importance of mentorship and support to their success.

Panelists:

- Harriet Crockett-Woods, Childrens Healthcare of Atlanta
- Melencia Johnson, University of South Carolina Aiken
- Nastassia N. Jones, Southern University and A&M College
- Lola Olufemi, National Institutes of Health

27. Criminal Legal System [Regular Paper Session]

Thursday | 3:30 pm-4:45 pm | Embassy West

Chair: Sherry Skaggs, University of Central Arkansas

- *Pre-prison Polyvictimization among Women Serving Life in Prison.*Ron Aday, Middle Tennessee State University, Nicole Seabold, Tennessee Tech University, Meredith Huey Dye, Middle Tennessee State University
- *A Network Perspective on Officer Diversity and Racial Disparity in Police Use of Force.*Scott Duxbury, University of North Carolina
- *School Safety Concerns in Adolescence and Criminal Offending in Short and Long Terms.*Vaun Baltimore, Middle Tennessee State University, Chloe Catherine Davenport, Middle Tennessee State University
- *Police-Community Relations: A National Analysis of Law Enforcement Personnel.*Sherry Skaggs, University of Central Arkansas
- *Do Perceptions of Justice Matter in Predicting Crime Victim Fear?.*Jessica Abbott, Utah Tech University, Shelly McGrath, University of Alabama at Birmingham

28. Sociology of Disaster [Regular Paper Session]

Thursday | 3:30 pm-4:45 pm | Forum East

Organizer: Ashleigh McKinzie, Middle Tennessee State University

Chair: Ashleigh McKinzie, Middle Tennessee State University

- *Mitigation Beliefs and Risk Perceptions: How Disaster Root Cause Attributions Impact Policy Support.*Marjorie Prokosch, Rochester Institute of Technology, Jessica W. Pardee, Rochester Institute of Technology
- *"Life is Too Short": Necropolitics in the Shadows of Corporate Governance.*Kasey Henricks, University of Illinois at Chicago

29. Sociology and Film/Television - Theory Mini-Conference [Regular Paper Session]
Thursday | 3:30 pm-4:45 pm | Forum West

Organizer: Harry F. Dahms, University of Tennessee - Knoxville
Chair: Joel Crombez, Kennesaw State University

- *Surviving the Post-Apocalypse: Station Eleven, Classical Education, and the Therapeutic Life.*[Joel Crombez, Kennesaw State University](#)
- *(D)evolution, Class, and Alienation in an Unexpected Science Fiction Film.*[Anthony J. Knowles, University of Tennessee-Knoxville](#)
- *'Brooklyn Nine-Nine' and Exploring Implicit(?) Copaganda on TV.*[Sukanya Bhattacharya, University of Tennessee-Knoxville](#), [Elliott Howard, University of Tennessee-Knoxville](#)

30. W.E.B. Du Bois and His Legacy of Critical Research on Race [Regular Paper Session]
Thursday | 3:30 pm-4:45 pm | International

Organizer: Melencia Johnson, University of South Carolina Aiken
Chair: Jessica McCarty, University of South Alabama

- *DuBois' Double Consciousness as Meta-Axiological Dilemma.*[Sundjata ibn-Hyman, Coppin State University](#)
- *The Talented Tenth: W. E. B. Du Bois' Social Justice Warriors.*[Earl Wright II, Rhodes College](#)
- *Unveiling the Power of Black Feminist Thought in Challenging U.S. Policing Methods.*[Emerald Jones, Alabama A&M University](#), [Mariyah Johnson, Alabama A&M University](#)

31. Poster Session [Poster Session]
Thursday | 3:30 pm-4:45 pm | Grand Ballroom East

Chair: Jessica Lynn Burke, Francis Marion University

- *Interpersonal Regret Choices among Undergraduates.*[Teagan Ainsley Slade, East Carolina University](#), [Emily Herrle, East Carolina University](#), [David Knox, East Carolina University](#), [Elizabeth Perkins, Morehead State University](#), [Joyce Chang, University of Central Missouri](#), [Lacey Ritter, Mount Mercy University](#)
- *Party At The Polls : Voter Registration Initiative.*[Jaycob Beasley, Tuskegee University](#)
- *Analyzing News Reports on Black Parent-Child Socialization to Explore Gender Neutrality.*[Mahir Mahmud Khan, Wichita State University](#)
- *A Comparative Analysis of Animal Cruelty Law Categories and Reported Incidents Across U.S. Regions.*[Shelly McGrath, University of Alabama at Birmingham](#), [Kirsten Tjarks, University of Alabama-Birmingham](#)
- *Remaining Together After an Affair.*[Lillian Griffin, East Carolina University](#)
- *Social Media and Public Opinion on Gun Control.*[Maruice Mangum, Jackson State University](#)
- *Retribution or Reform? A Qualitative Analysis of Racial and Gendered Opinions towards Rehabilitative Justice.*[Emil M Cucksee, University of Alabama in Huntsville](#)
- *Interpersonal Regrets among Undergraduates.*[Emily Michele Herrle, East Carolina University](#), [Teagan Ainsley Slade, East Carolina University](#), [David Knox, East Carolina University](#)

32. Multi-Initiative Collaboration Between Sociology and Criminal Justice Programs [Roundtable]
Thursday | 3:30 pm-4:45 pm | Jackson

Organizer: Courtney Waid, Auburn University at Montgomery
Chair: Courtney Waid, Auburn University at Montgomery
Discussants:

- Kimberly Brackett, Auburn University at Montgomery
- David Feltmate, Auburn University at Montgomery
- Brett Lehman, Auburn University at Montgomery
- Jacqueline McNett, Auburn University at Montgomery
- Sarah Napper, Auburn University at Montgomery
- Theresa Pelfrey, Auburn University at Montgomery
- Courtney Waid, Auburn University at Montgomery
- Lauren Norman, University of North Carolina Pembroke

33. 50th Commemorative Panel II: Sociology, 50 Years Forward [Panel]
Thursday | 3:30 pm-4:45 pm | Embassy East

Chair: Anita Bledsoe-Gardner, Johnson C. Smith University
Panelists:

- David C. May, Mississippi State University
- Roma Hanks, University of South Alabama
- DeMond Miller, Rowan University
- Stephen Davis, Arizona State University

34. Innovative Approaches in Qualitative Research: New Horizons and Methods [Regular Paper Session]
Thursday | 5:00 pm-6:15 pm | Embassy East

Organizer: Kristie Perry, Southern University and A&M College
Chair: Julietta Raymond, Southern University and A&M College

- *Students Attitudes on College Education: Qualitative Study.*[Ashraf Esmail, Dillard University](#)
- *Overcoming Barriers to Grant-Funded Qualitative Research in Universities: Challenges and Solutions |.*[Kristie Perry, Southern University and A&M College, Julietta Raymond, Southern University and A&M College](#)
- *Moving from Quantitative to Qualitative Research: Shifting Research Methods to Understand the Challenges Animal Advocates Face.*[Shelly McGrath, University of Alabama at Birmingham](#)

35. Undergraduate Research II [Regular Paper Session]
Thursday | 5:00 pm-6:15 pm | International

- *ADHD and Academic Well-Being.*[Andrea Rene Patton, Berea College](#)

- *Death Anxiety, Religion, and Religiosity: A Quantitative Research Report.*[Kaitlyn Sarah Nicole Ferguson, Berea College](#)
- *The Sense of Belonging Among Berea College Students.*[Ilaisa`ane Leetham, Berea College](#)
- *College Capital: Social and Cultural Capital Development and What it Means for Pell-Eligible Students Aiming for Upward Mobility in Higher Education.*[Andrea Woodward, Berea College,](#) [Lily Barnette, Berea College,](#) [Ethan Elliot Crofts, Berea College,](#) [Ülvi Gitaliyev, Berea College](#)

Southern Illinois University Carbondale Meet Up

Thursday | 6:30 pm-7:00 pm | Maxwell's Lounge

All faculty, students, alumni and friends of Southern Illinois University Carbondale are invited. Let us gather and catch up!

FRIDAY, OCTOBER 18, 2024

Breakfast

Friday | 7:00 am-8:30 am | Grand Ballroom East

Available for registered MSSA conference participants.

Small and Community Colleges Caucus Breakfast

Join other faculty, staff and students from small and community colleges for breakfast.

Friday | 7:00 am-8:30 am | Grand Ballroom East

Registration

Friday | 8:00 am-5:00 pm | Promenade

Quiet Room

Friday | 8:00 am-5:00 pm | Johnson

This room is open as a quiet space to work on projects or step away from the noise of the conference.

36. Environmental Crime/Harm and Justice Issues [Regular Paper Session]

Friday | 8:00 am-9:15 am | Embassy East

Organizer: Lisa A. Eargle, Francis Marion University

Chair: Jessica Lynn Burke, Francis Marion University

- *Let's Talk about Fast Fashion: Patterns of Consumerism among College Students in the U.S. Rural South.*[Cara Elizabeth Martin, UNC Charlotte,](#) [Melanie Anne Escue, University of North Carolina at Pembroke](#)
- *Investigating the Socio-Ecology of the Renewable Energy Supply Chain: Lessons from Extraction in Appalachia and the Future of Extraction in the Global North.*[Patrick Clemens, University of Tennessee, Knoxville](#)
- *Blue Hegemonies: Confluences of Geocultural Power in the Pacific.*[Julian Aaron Padgett, University of Missouri](#)

37. Reproductive Justice in the Deep South [Regular Paper Session]
Friday | 8:00 am-9:15 am | Embassy West

Organizer: Ashleigh McKinzie, Middle Tennessee State University
Chair: Autumn Rena Martin, University of Louisville

- *Navigating Women's Healthcare in a Post-Dobbs Era: The Maternal and Reproductive Healthcare Crisis in Kentucky and Tennessee.*[Autumn Rena Martin, University of Louisville](#)
- *Subordinate Bodies: The Sociological Ramifications of Recent Supreme Court Decisions.*[Lauren Warren, Centenary College of Louisiana](#)
- *Examining Race and Gender Variation in Abortion Opinions.*[Michaela Patsy Robinson, Fisk University](#), [Meagan Rainock, Fisk University](#)
- *Religion in Politics: Evaluating the Influence of Religiosity on State Abortion Bans Post Dobbs.*[Vanessa Greenslade, Southern University](#)

38. Undergraduate Research III [Regular Paper Session]
Friday | 8:00 am-9:15 am | Forum East

Chair: Theresa Clare Davidson, Samford University

- *Gendered Fear of Crime.*[Mary Baker, Samford University](#)
- *The Relationship between Individualism & Mental Health.*[Katie McGinley, Samford University](#)
- *Acculturation vs. Religiosity of Latinos in the U.S.*[Shaun Patrick O`Neil, Samford University](#)
- *Hispanic Disaggregation and Variation in Social Capital Access.*[Eli Golde, University of Florida](#)

39. Social and Cultural Capital: Researching Access and Understanding Barriers [Regular Paper Session]
Friday | 8:00 am-9:15 am | Forum West

Chair: Austin W Ashe, Norfolk State University

- *Morality is Not Blind: A Racialized Approach to Understanding Morality.*[Austin W Ashe, Norfolk State University](#)
- *Culture of Poverty: Meta-Axiological Dilemma as Occludent to Social Capital Development.*[Sundjata ibn-Hyman, Coppin State University](#)
- *Veteran Food Insecurity: Social and Structural Barriers to Accessing Food Assistance Programs after Military Service.*[Jimmy Joe Esquibel, Oklahoma State University](#)
- *Influences of Poverty.*[Amari Geneva Brown, Norfolk State University](#)
- *Hot Dog Consumption in the Mountain State.*[Boniface Noyongoyo, Marshall University](#)

40. Creating an Individualized Development Plan for Promotion and Tenure [Workshop]
Friday | 8:00 am-9:15 am | International

Organizer: Erin L Rider, Nevada State University
Chair: Erin L Rider, Nevada State University

This session will help faculty, and grad students, develop a 1-5 year plan for promotion and tenure. We will focus on identifying tasks by promotability and building in accountability. Further we will create a useful time management plan to achieve work/life balance and reduce burnout.

41. Outside the Box: New, Creative, or Innovative Approaches to Social Research [Regular Paper Session]

Friday | 9:30 am-10:45 am | Embassy West

Organizer: Stephen Davis, Arizona State University

Chair: Stephen Davis, Arizona State University

- *Fixed Points for Relative Sociology: The New Technology Approach.*[Christopher Elliott, UNCW](#)
- *Museums, Stadiums, & the Potential of Public Places in Sociological Research.*[J. Sumerau, University of Tampa](#)
- *Minding the Gap: Client Professionalization of End-of-Life Doulas.*[Sarah Beth Donley, Jacksonville State University](#), Casey Fannin, Jacksonville State University
- *Using Quantitative Ethnography and Epistemic Network Analysis to Explore Social and STEM Identity.*[Nastassia N. Jones, Southern University and A&M College](#)
- *Corporate Leadership in a Racist Community: Integrating the Sociological Histories of Coffee, Slavery, and the Klan at Nashville's Maxwell House Hotel (1859-1961).*[Stephen Davis, Arizona State University](#)

42. Undergraduate Research IV [Regular Paper Session]

Friday | 9:30 am-10:45 am | Forum East

Organizer: Meredith Huey Dye, Middle Tennessee State University

Chair: Umang Dhingra, Duke University

- *Protecting the American Family: Preserving Familial Intimacy and Cohesiveness during Parental Incarceration.*[Umang Dhingra, Duke University](#)
- *Long-Term Economic and Financial Effects of School Bullying.*[Naman Kumar, Ransom Everglades School](#), Yosef Bonaparte, University of Colorado at Denver
- *Toy Story: A Content Analysis of Sex Toys.*[Fletcher Nicholas Wilson, University of Alabama in Huntsville](#)
- *Autism and BDSM: The Impact of Communication within Sexual Scripts.*[Alex Watts, University of Georgia](#)

43. Media, Music, and Popular Culture [Regular Paper Session]

Friday | 9:30 am-10:45 am | Forum West

Organizer: Ruth Chananie, University of Tampa

Chair: Ruth Chananie, University of Tampa

- *Creepy Comics and Rostow's Stages of Development: Construction of the Underdeveloped Third World in Horror Comics.*[Stanley Adam Veitch, Tuskegee University](#)

- “*She-Who-Must-Not-Be-Named*”: *Examining Identity and Behavior Change in the Harry Potter Fandom*.Tierra James, Auburn University, Jacob Church, Jacksonville State University, [Brianna Turgeon, Jacksonville State University](#), Leonela Martinez Ramirez, Jacksonville State University, Ariel Vicars, Jacksonville State University, Alicia Carter, University of Tennessee-Knoxville
- *The Role of Macroaggressions in the “Blind Curtain” Selection Process of National Symphony Orchestras: A Symbolic Interactionist’s Perspective*.[Edward Sanford, Tennessee State University](#)
- *Consumer Perspectives on True Crime Media Representations*.[Kailee E.D. Lancaster, University of North Carolina Wilmington](#)

44. Maintaining an Active Research Agenda at a Teaching Institution [Panel]

Friday | 9:30 am-10:45 am | Embassy East

Organizers: Jessica Abbott, Utah Tech University; Aaron Rowland, University of Tennessee-Martin; This panel is comprised of faculty at teaching institutions who will provide tips, guidance, and other ideas for maintaining an active research agenda. Audience participation is encouraged.

Panelists:

- Jessica Abbott, Utah Tech University
- Aaron Rowland, University of Tennessee-Martin
- Brett Lehman, Auburn University at Montgomery
- John McCollum, Southwestern Community College

45. Race, Social Media, and Politics [Panel]

Friday | 9:30 am-10:45 am | International

Organizer: Marcus Brooks, Western Kentucky University

Chair: Melanie Anne Escue , University of North Carolina at Pembroke

- *Which Black Lives Matter?: An Examination of Black Conservative Views on Abortion and Policing*.[Keziah Monk, Western Kentucky University](#)
- *Colorblind Nationalism: Toward a New Theory of New Racism for the Modern United States*.[Marcus Brooks, Western Kentucky University](#)
- *A Sociological Glimpse into America’s Future if Project 2025 is Enacted*.[Robert K. Perkins, Norfolk State University](#), Cameron Foreman, Norfolk State University, Micaiah Stephens, Norfolk State University
- *Ethnic Demographics in Focus: A 2020 U.S. Census Study of Turkish and Kurdish Communities*.[Ismail Yigit, Tennessee State University](#)

46. Homicide Studies [Regular Paper Session]

Friday | 11:00 am-12:15 pm | Embassy East

Organizer: John Boulahanis, Southeastern Louisiana University

Chair: John Boulahanis, Southeastern Louisiana University

- *Tarnowsky: Exposing her influence on theories of homicide.. ..*[Lin Huff-Corzine, University of Central Florida](#), Kayla Toohy, University of Tampa
- *Homicide Cases: Examining Exceptionally Cleared to Open Cases.*[John Boulahanis, Southeastern Louisiana University](#)
- *Segregation and its Impact on Hispanic Homicide: The Use of the Index of Qualitative Variation as a Measure of Internal Hispanic Segregation.. ..*[Michael Bisciglia, Southeastern Louisiana University](#)

47. Sexuality, Gender, and Policy [Regular Paper Session]

Friday | 11:00 am-12:15 pm | Embassy West

Organizer: Andrea Nicole Hunt, University of North Alabama

Chair: Andrea Nicole Hunt, University of North Alabama

- *"I thought I was just a late bloomer": Exploring asexual people's experiences of identity and community.*[Jennifer Patrice Sims, University of Alabama in Huntsville](#), Jess Walter, University of Alabama-Huntsville
- *Tying Down Safety: A Gender-Based Analysis of BDSM Product Reviews.*[Tina Deshotels, Jacksonville State University](#)
- *The Gendered Agency Penalty in the Race for the U.S. Presidency.*[Christianne Marie Corbett, University of Arkansas](#)

48. Undergraduate Research V [Regular Paper Session]

Friday | 11:00 am-12:15 pm | Forum East

Chair: Kristie Perry, Southern University and A&M College

- *Seven Deadly Sins in Fashion: Exploring the Intersectionality of Religion, Clothing, and Emotions.*[Janeice Allen, Southern University and A&M College](#)
- *An Exploration of Voter Apathy in Louisiana: Implications for Policy.*[Jareh Buchanan, Southern University and A&M College](#)
- *An Assessment of Foreign Language Exposure and Media Consumption.*[Ashanti Scott, Southern University and A&M College](#)
- *Addressing Reparative Justice for Black Louisiana Slave Descendants with Implications for Public Policy.*[Marshall Wilson, Southern University and A&M College](#)
- *An Assessment of Hospice Care on Patients Quality of Life.*[Ashton Merrett, Southern University and A&M College](#)

49. Author Meets Curious Readers: Gratuitous Angst in White America [Panel]

Friday | 11:00 am-12:15 pm | Forum West

Organizer: Marcus Brooks, Western Kentucky University

Chair: Marcus Brooks, Western Kentucky University

Join us for an engaging "Author Meets Curious Readers" session featuring *Gratuitous Angst in White America: A Theory of Whiteness and Crime* by Deena A. Isom. This groundbreaking book introduces a new criminological theory that examines how whiteness influences deviant and criminal behaviors among white individuals, and why they are treated differently by the criminal justice system.

Challenging traditional perspectives, the author offers an intersectional framework that sheds light on America's racialized history and current societal divides. A panel of experts will discuss these compelling insights with the author present, offering a unique opportunity for lively discussion and critical reflection. Please stay after for a special book signing opportunity.

Panelists:

- Deena Isom, University of South Carolina
- Sarah Castillo, University of Tennessee

50. Experiential Learning: Using Monopoly to Teach about Social Justice [Workshop]

Friday | 11:00 am-12:15 pm | International

Organizer: Rebecca K Davison, Morehead State University

This interactive workshop will demonstrate how the game of Monopoly (in modified versions) can be used as a tool to engage students in the exploration of equity and equality. This modified version has numbered envelopes that determine each participant's situation for the game. Some participants begin with property and additional money. Some have "special rules" they must follow. And, not all participants start at "Go." This activity stimulates dynamic classroom discussions and challenges students to reflect deeply on their assumptions about power and privilege. This teaching tool can be used by instructors to teach concepts about antiracism, and social and economic justice and create a space for students to self-reflect, self-regulate, and increase their social empathy towards people with different lived experiences. The workshop will include a brief history and overview of the game, an interactive demonstration of how the game can be adjusted to teach concepts and engage students in discussions about social and economic justice, and research findings related to social empathy levels using the Social Empathy Index (SEI) developed by Segal, Wagaman, and Gerdes (2012). **LEARNING OUTCOMES:** 1. Participants will understand the benefits of experiential learning as a holistic approach to teaching about social justice. 2. Participants will learn a variety of ways to use the game of Monopoly to teach concepts and facilitate classroom discussions around racial, social, and economic justice.

Discussants:

- Monica Himes, Morehead State University
- Rebecca K Davison, Morehead State University

Professional Headshots

Friday | 11:00 am-12:15 pm | Far Promenade

Need a professional headshot? Drop by and have your photo taken. Photos will be delivered via share drive after the conference.

Racial and Ethnic Minorities Caucus Luncheon

Friday | 12:30 pm-1:30 pm | Grand Ballroom East

Chair: Jessica McCarty, University of South Alabama

A time for members and researchers of racial and ethnic minorities to gather. A limited number of lunches will be provided for registered MSSA Conference attendees.

51. Plenary: Leading with Equity

Friday | 2:00 pm-3:15 pm | Grand Ballroom West

President: Melencia Johnson, University of South Carolina Aiken

Sharon K. Roberson, Esq. is a seasoned C – Suite executive with 30+ years of experience in the corporate, government, and nonprofit sectors. She’s served as President and CEO of YWCA Nashville & Middle Tennessee since 2016. In that time, she’s broadened the agency’s services by expanding the Weaver Domestic Violence Center, creating a children’s program at shelter, and opening the largest DV pet shelter in Tennessee. She’s overseen the expansion of all school-based and adult education programming. Sharon’s renewed the agency’s focus on racial justice, implementing a dedicated social justice program, which has led to several new laws in Tennessee. During her tenure, the YWCA has also received the largest single donation in its 125-year history. Sharon has been recognized with numerous awards and in 2018, she and the organization were selected Person/Organization of the Year by the Tennessean newspaper. Sharon earned her undergraduate and law degrees from Vanderbilt University.

Keynote Speaker: Sharon Roberson, YWCA of Nashville and Middle Tennessee

Discussant: Andrea Nicole Hunt, University of North Alabama

52. Discrimination, Health and Mental Health [Regular Paper Session]

Friday | 3:30 pm-4:45 pm | Embassy East

Organizers: Whitney Frierson, Vanderbilt University; Meagan Rainock, Fisk University;

Chair: Whitney Frierson, Vanderbilt University

- *A Qualitative Investigation of Microaggressions, Coping Strategies, and Well-Being among Black Men and Black Women Ph.D. Students.*[Whitney Frierson, Vanderbilt University](#)
- *Caste and Mental Health in Nepal.*[Sanjeev Acharya, Arkansas State University](#)
- *Depression in Marginally Food Secure Households.*[Aimee Imlay, Mississippi State University](#), [Margaret Ralston, Mississippi State University](#)
- *Advocating for a Culture of Referral: The Social Epidemiology Behind Endometriosis Education.*[Angela Allgood Crouse, University of Mississippi](#)
- *Understanding the Link Between Juvenile Delinquency and Mental Health.*[James Bush, Let’s Have Manversation](#)

53. Looking Back: A History of Germantown in North Nashville [Panel]

Friday | 3:30 pm-4:45 pm | Forum East

Organizer: Katherine Everhart, University of Virginia at Wise

Chair: Katherine Everhart, University of Virginia at Wise

Our panel will examine the social and cultural history of one of Nashville’s oldest neighborhoods—that of Germantown. Located just north of the Capitol, the first suburb of North Nashville was established in the 1850s by German and Swiss immigrants. By the 1920s, many of the initial families in the neighborhood had moved away from Germantown into other areas of Nashville, in part due to urban developments in transportation and an anti-German sentiment in the post-WWI era. From the 1920s to the late 1970s, the neighborhood would experience social and political and economic changes like

most U.S. cities—leading to a mostly hollowed out, increasingly industrial, area in disrepair. In the late 1970s, a small group of individuals moved into the neighborhood began the process of preserving historic structures, protecting the neighborhood’s character, and fostering community cohesion. In 1979, the neighborhood was listed in the National Register of Historic Places. Looking back across the last four and a half decades, the neighborhood of Germantown has experienced considerable change—now often described as “one of the most well-traversed destinations” in Nashville and a place in which “boutiques with thoughtfully curated wares sit cheek to cheek with local restaurants helmed by James Beard Award-winning chefs.” Panel of Current and Former Residents include: Berdelle Campbell, retired state government employee, founding member of Cumberland River Compact and Nashville’s Greenway System. Campbell has been a resident of the Germantown neighborhood for 43 years. Barbara Carroll, retired from Vanderbilt University as Associate Vice Chancellor and Chief HR Officer, moved to Germantown in 1986, left in the 1990s, and returned in 2015 to renovate one of the community’s oldest homes. George Zepp, retired as editor and columnist after a 33-year career at *The Tennessean* newspaper, author of the book *Hidden History of Nashville*, 23-year resident of Germantown.

Panelists:

- Katherine Everhart, University of Virginia at Wise
- Valeria Eadler, Middle Tennessee State University

**54. 50th Commemorative Panel III: Sociology, 50 Years Forward [Panel]
Friday | 3:30 pm-4:45 pm | Grand Ballroom West**

Chair: Earl Wright II, Rhodes College

Panelists:

- Marcus Brooks, Western Kentucky University
- Andrea Nicole Hunt, University of North Alabama
- Anita Bledsoe-Gardner, Johnson C. Smith University
- Giselle Greenidge, Northwest Missouri State University

**55. Let's Get Ready to Advance [Workshop]
Friday | 3:30 pm-4:45 pm | Embassy West**

Chair: Jessica McCarty, University of South Alabama

The growth of educational programs and the recruitment of talented and diverse students are essential components of institutional expansion. In this abstract, I will delve into strategies of effective program expansion and recruitment enhancement strategies, drawing from various scholarly sources and best practices. This research-driven approach ensures that programs are aligned with industry demands, relevant, and appealing to prospective students. Additionally, strategic partnerships with other educational institutions, industry organizations, and community stakeholders can significantly enhance program growth and recruitment efforts. Collaborative initiatives such as articulation agreements, internships, and joint events create additional resources and opportunities for learners, expanding the institution's reach and visibility among potential students. Effective marketing and communication strategies are vital in attracting and engaging prospective students. Implementing a

comprehensive digital marketing campaign, including social media, search engine optimization, and targeted advertising, can effectively reach a wider audience and generate interest in the program.

Undergraduate Networking Session

Friday | 3:30 pm-4:45 pm | Grand Ballroom East

Network with other undergraduate students attending the conference. Sponsored by Alpha Kappa Delta International Sociology Honor Society.

56. Organizing Your Workplace in a Right-to-Work State

Friday | 3:30 pm-4:45 pm | International

Chair: Rachel E. Davis, Middle Tennessee State University

In this workshop, experienced worker-organizers affiliated with United Campus Workers will demonstrate the importance of workplace organizing in right-to-work states, particularly for higher education workers, and will guide participants through the organizing process.

Remembering Departed MSSA Members

Friday | 5:00 pm-5:30 pm | Grand Ballroom West

Organizer: Theresa Clare Davidson, Samford University

Join us and share your memories of members of MSSA who have departed over the last 50 years.

President's Closing Reception

Friday | 5:30 pm-6:30 pm | Crown Ballroom

Let's close out MSSA 2024 with a farewell reception. All registered attendees are welcome to attend. A limited number of drink tickets available on a first come basis.

Business Meeting and Awards Banquet

Friday | 6:30 pm-9:00 pm | Crown Ballroom

Open to all registered MSSA conference attendees.

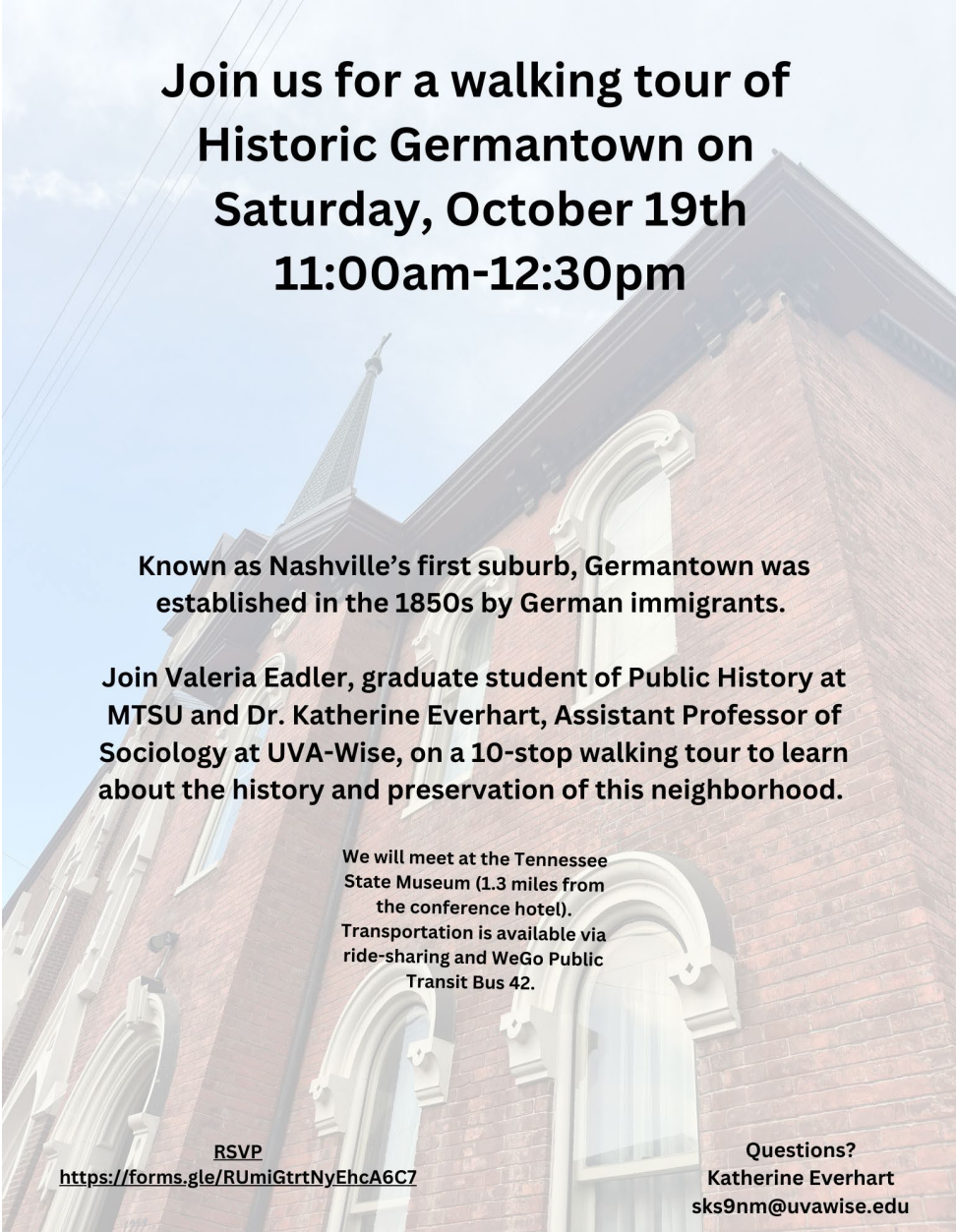

**Join us for a walking tour of
Historic Germantown on
Saturday, October 19th
11:00am-12:30pm**

Known as Nashville's first suburb, Germantown was established in the 1850s by German immigrants.

Join Valeria Eadler, graduate student of Public History at MTSU and Dr. Katherine Everhart, Assistant Professor of Sociology at UVA-Wise, on a 10-stop walking tour to learn about the history and preservation of this neighborhood.

We will meet at the Tennessee State Museum (1.3 miles from the conference hotel). Transportation is available via ride-sharing and WeGo Public Transit Bus 42.

RSVP

<https://forms.gle/RUmiGtrtNyEhcA6C7>

Questions?

**Katherine Everhart
sks9nm@uvawise.edu**

SATURDAY, OCTOBER 19, 2024
VIRTUAL POST CONFERENCE
ALL SESSIONS ON ZOOM (Central Daylight Time)

Executive Council Meeting

Saturday | 8:30 am-10:00 am | Polk

57. Theorizing U.S. Undergraduate Education: Boyer 2030 - Theory Mini-Conference [Panel]

Saturday | 8:00 am-9:15 am | Virtual 4

Organizer: Harry F. Dahms, University of Tennessee - Knoxville

Chair: Harry F. Dahms, University of Tennessee - Knoxville

Panelists:

- Steven Dandaneau, Colorado State University
- Joel Crombez, Kennesaw State University
- Alexander Stoner, Northern Michigan University
- Charles Walton, Houston Community College
- Harry F. Dahms, University of Tennessee - Knoxville

58. Social Determinants of Health and Well-Being [Regular Paper Session]

Saturday | 9:30 am-10:45 am | Virtual 1

Chair: Kristen Nicole Sobba, Southeast Missouri State University

- *Beyond Genetics: The Social Structural Determinants of Health.*[Aida Wisecup, Missouri State University](#)
- *The association between health-related locus of control and BMI and health behaviors among college students..*[Miranda Reiter, University Of North Carolina Pembroke](#), [Abigail Reiter, UNC Pembroke](#)
- *Advising Styles & Quality: An Assessment of Graduate Students' Beliefs on Advising.*[Kristen Nicole Sobba, Southeast Missouri State University](#)
- *Length of US Residence and Mental Health among Asian American Immigrants.*[Ying Ma, Austin Peay State University](#)
- *Forced Therapy vs. Educational Opportunities: Counteracting Cognitive Behavioral Programs in Prison.*[Jennifer Schlosser, Coastal Carolina University](#)

59. Student Perceptions of Satisfaction and Learning [Regular Paper Session]

Saturday | 9:30 am-10:45 am | Virtual 2

Chair: Cameron Taylor Graham, University of Tennessee at Knoxville

- *Exploring Student Perceptions of Infographic Creation in an Undergraduate Social Inequalities Course: A Mixed-Methods Study.*[Makeela Johari Wells, Auburn University](#)

- *Metaphors and Social Reflections: Using Cinematic Sociology to Aid Instruction.*[Cameron Taylor Graham, University of Tennessee at Knoxville](#)
- *Incorporating Sociology “Labs” into an Introductory Sociology Course.*[Deborah Lowry, University Of Montevallo](#)
- *Determinants of difference: Understanding racial differences in college student satisfaction.*[Philip B Mason, University of South Carolina Aiken, Michelle Petrie, University of South Carolina Aiken](#)

60. Teaching Survey Courses to Freshman and Sophomores [Regular Paper Session]
Saturday | 9:30 am-10:45 am | Virtual 3

Organizer: Matthew West, Lawson State Community College

Chair: Matthew West, Lawson State Community College

- *Cultural Scavenger Hunt.*[Katie Patton, Delgado Community College](#)
- *Divisive Concept Laws and Intro to Sociology Courses.*[Thomas Moore, Columbia State Community College](#)
- *Diversity Icebreaker Activity.*[Amy Skinner, Shelton State Community College](#)
- *Designing a Religion: How Institutions Work in Society.*[M. Kelly James, University of Memphis](#)
- *Hot Topics.*[Likita Wyatt, Lawson State Community College](#)
- *Family Budget Exercise and the Transition to the Digital World.*[Michael Traugot, Columbia State Community College](#)

61. Critical Social Theory and Politics - Theory Mini-Conference [Regular Paper Session]
Saturday | 9:30 am-10:45 am | Virtual 4

Organizer: Harry F. Dahms, University of Tennessee - Knoxville

Chair: Harry F. Dahms, University of Tennessee - Knoxville

- *Understanding Climate Disavowal: A Directed Qualitative Content Analysis of Technological Fetishism in U.S. Newspaper Articles on A.I. and Climate Change.*[Alexander Stoner, Northern Michigan University](#)
- *Toward a Critical Theory of Global EV Adoption.*[Anthony J. Knowles, University of Tennessee-Knoxville](#)
- *Critical Theory in the Field: Reflections on Fieldwork Experiences from Nashville to Kurdistan.*[Stephanie Gibb-Clark, Iowa State University](#)
- *Humans Eating Animals: Natural, Healthy, and Humane - or the Opposite?.*[Nadya Vera, University of Tennessee-Knoxville](#)

62. Undergraduate Research in Progress: Sociology of Deviance [Regular Paper Session]
Saturday | 9:30 am-10:45 am | Virtual 5

Chair: Melencia Johnson, University of South Carolina Aiken

- *Exploring Perceptions of Deviant Sexuality in Elementary.*[Ayondayla Abney, University of South Carolina Aiken](#)

- *An Examination of Motivations for Drug Use in Breaking Bad.*Trenton Appleford, University of South Carolina Aiken
- *Social Media and Young Women's Body Image.*Ashtin Barton, University of South Carolina Aiken
- *Status and Victimization Risks of Women in Gangs.*
- *Social Media, Suicide Contagion, and the Blue Whale Challenge.*

Discussants:

- Ayondayla Abney, University of South Carolina Aiken
- Ashtin Barton, University of South Carolina Aiken
- Emily Copley, University of South Carolina Aiken
- Chloe Powell, University of South Carolina Aiken
- Trenton Appleford, University of South Carolina Aiken

**63. Leveraging Social Networks, Media, and Environment [Regular Paper Session]
Saturday | 11:00 am-12:15 pm | Virtual 1**

Organizer: Kristen Nicole Sobba, Southeast Missouri State University

Chair: Kristen Nicole Sobba, Southeast Missouri State University

- *Responses to Viewing Cyberbullying Victimization: Examining College Students' Perspectives.*Kristen Nicole Sobba, Southeast Missouri State University, Monica Bixby Radu, Southeast Missouri State University
- *Towards a Holistic, Age-Graded Understanding of Excessive Internet Use: An Application of Containment Theory.*Marian Borg, University of Florida, Ryan Jackson Howard, University of Florida
- *Navigating Barriers to Healthcare: A Case study of one Hispanic Church as a Site of Community Cultural Wealth.*Katie Knop, Wingate University, Jaqueline Hernandez-Ramos, Wingate University
- *Following Trends or Principled Decision Making? Evaluating the Influence of NLP Benchmarks on Digital Sociology.*AJ Alvero, Cornell University, Ruohong Dong, University of Florida, Klint Kanopka, New York University, David Lang, Stanford University
- *"Eco-Friendly Solutions for Enhancing Urban Resilience: A Case Study Fostering Environmental Sustainability to Combat Homelessness in Skid Row, Los Angeles, California".*Cameron Sumlin, University of Louisiana, Monroe, Ogbonnaya Nwoha, Louisiana Tech University, Lemmy Akoma, Grambling State University, Frances Staten, Grambling State University

**64. Understanding Ethnicity and Gender Based Attitudes and Violence [Regular Paper Session]
Saturday | 11:00 am-12:15 pm | Virtual 2**

Chair: Anjolaoluwa Joy Ogunsina, Auburn University

- *Understanding the causes of violence against wives in Bangladesh: An Analysis of Husbands' and Wives' Perspectives.*Farah Tasneem, University of Georgia

- *“He Called Me a Whore”*: Campus Preachers Acting as Gatekeepers at the Intersection of Gender, Sexuality, and Christianity.Mandi N. Barringer, University of North Florida, Brenda Savage, Louisiana Tech University
- *Fresh off the Boat No More? Christian Nationalism and Attitudes Toward US Immigration Policies Among US Asians.*Fanhao Nie, UMass Lowell
- *“Even If It's Not Super Radical or Direct Action, It All Still Matters:” Occupational Activism in the Weight-Inclusive Healthcare Movement.*Gabriele Jaclyn Gomez , Oklahoma State University

65. Gender, Sexuality, and Race [Regular Paper Session]

Saturday | 11:00 am-12:15 pm | Virtual 3

Chair: Christa Moore, The University of Virginia's College at Wise

- *Queer and Thriving? Community as Resilience in an Anti-LGBTQ State.*Lauren Nicole Aitken, University of Central Florida
- *Equitable Funding Achievement: Exploring Workload Allocation Inequalities Among STEM Faculty.*Colby Ryan Kopf, University of Central Florida, Amanda Koontz, University Central Florida
- *The Impact of Social Media Algorithms on Black Artists Through a Black Feminist Lens.*Nakaja Weaver, Missouri State University
- *Child Welfare Cultures: Identifying Gendered Barriers to State-Specific and Nationwide Child Protective Services..*Christa Moore, The University of Virginia's College at Wise

66. Critical Theory, Dialectic of Enlightenment, and Adorno's Sociology - Theory Mini-Conference [Regular Paper Session]

Saturday | 11:00 am-12:15 pm | Virtual 4

Organizer: Harry F. Dahms, University of Tennessee - Knoxville

Chair: Alexander Stoner, Northern Michigan University

- *Adorno Predicted Trump: "Zur Prädisposition für demagogische Beeinflussung" as a Defining Theme and Problem.*David Smith, University of Kansas
- *Adorno as Fieldworker?.*Steven Dandaneau, Colorado State University
- *Classical Sociology and the Dialectic of Enlightenment.*Dan Krier, Iowa State University
- *Severance as Perseverance: Negation of Subjectivity in a Fragmented World.*Reha Kadakal, California State University Channel Islands

67. Poster Session II [Poster Session]

Saturday | 11:00 am-12:15 pm | Virtual 5

Chair: Jessica W. Pardee, Rochester Institute of Technology

- *Spatial Analysis of Economic Disparities in West Virginia - What are they?.*Terence Amankatoa Asitibasi, Clemson University
- *Participant Perspectives on the WIC program in Mobile, AL.*Hosik Min, U of South Alabama, Roma Hanks, University of South Alabama

- *Exploring the Influence of General Strain Theory on the Relationships Between Childhood Maltreatment and Adulthood Prescription Drug Misuse.*Abby Gray Williamson, University of Central Florida , [Thomas Stafford Jones, University of Central Florida](#)
- *Compassion Fatigue in Kentucky Animal Shelter Workers.*[Elizabeth Perkins, Morehead State University](#), Suzanne Tallichet, Morehead State University, Matthew Fitch, Morehead State University

68. Walking Tour of Historic Germantown

Saturday | 11:00 am-12:30 pm | Germantown Tour

Organizer: Katherine Everhart, University of Virginia at Wise

Chair: Valeria Eadler, Middle Tennessee State University

Saturday, October 19th 11:00am-12:30pm Starting Point: Tennessee State Museum, 1000 Rosa L Parks Blvd Note: This tour is limited to the first 20 people to sign up. Contact: Katherine Everhart, sks9nm@uvawise.edu

69. Disease, Disaster, and the Environment [Regular Paper Session]

Saturday | 2:00 pm-3:15 pm | Virtual 1

Organizer: DeMond Miller, Rowan University

Chair: Micah Pyles, Western Carolina University

- *Xenophobia, Immigration and Disease.*[Abigail Reiter, UNC Pembroke](#), Aziza Samieva, Wake Tech Community College
- *Reflections on Race-based Urban Health Disparities: Lessons Learned from the COVID-19 Pandemic.*[Micah Pyles, Western Carolina University](#), Asa Iacobucci, Bridgewater State University, Liam Downey, University of Colorado, Boulder, Adenife Modile, University of Colorado, Boulder
- *Power Elite Theory in Global Environmental Conflicts.*[Emily Katherine Swanson, University of Florida](#)
- *Angle of Attack: The 737 MAX Tragedy Frame and the Discrediting of DEI.*[Milton Vickerman, University of Virginia](#)
- *The Dark Side of Vicarious Citizenship.*[Jeffrey Parker, University of New Orleans](#), Ciel Quebedeaux, University of New Orleans

70. Sociology of the Profession [Regular Paper Session]

Saturday | 2:00 pm-3:15 pm | Virtual 2

Chair: Deniz Yucel, William Paterson University of New Jersey

- *Co-visioning a Transformed Society through Precariously Employed Subjects of Disablement's Critiques of Productivity.*[Ioana Cerasella Chis, University of Birmingham](#)
- *"Strangers" of the Academy: Cultural Capital Influencing the Career Mobility and Integration of Immigrant Faculty in U.S. Higher Education.*[Debaleena Ghosh, Georgia Southwestern State University](#)

- *Teachers are not your politicians: The disconnection between teachers' agency and the political atmosphere of the classroom.*[Alicia Walker, Missouri State University](#), [Madeline Cope, Missouri State University](#)
- *From Office to Home: How Meaningful Work Shapes Well-Being Across Locations.*[Deniz Yucel, William Paterson University of New Jersey](#)

71. Theorizing the Apocalypse: Constructive Approaches to Crises - Theory Mini-Conference [Regular Paper Session]

Saturday | 2:00 pm-3:15 pm | Virtual 4

Organizer: Harry F. Dahms, University of Tennessee - Knoxville

Chair: Harry F. Dahms, University of Tennessee - Knoxville

- *Teaching the Economic Apocalypse.*[Adam Rafalovich, Pacific University](#)
- *Apocalyptic Imagery, Normative Structures of Collective Life and the Search of New Forms of Social Mediation.*[Reha Kadakal, California State University Channel Islands](#)
- *How to Avoid the Apocalypse? Towards the Societal Rationalization of the Economy.*[Harry F. Dahms, University of Tennessee - Knoxville](#)
- *Ecological Crisis and Ecological Crisis Diagnosis.*[Roderick Condon, Trinity College Dublin](#)

72. Teaching Health Professions Students [Workshop]

Saturday | 2:00 pm-3:15 pm | Virtual 3

Organizer: Xan Nowakowski, Florida State University

This interactive workshop sponsored by the Committee on the Profession will orient participants to effective approaches for teaching health professions students at various stages of career development. Our presenters each have over a decade of experience teaching health professions learners in undergraduate, post-baccalaureate, graduate, and professional degree and certificate programs. Both presenters also work with practicing clinicians for continuing education, providing both general interdisciplinary sociomedical science enrichment and detailing on specific related care competencies. Possible topics for group discussion include classroom activities for learners in different stages and types of clinical education, barriers faced by students pursuing health professions careers and how to address them, helpful resources for learners in diverse training and practice pathways, navigating an increasingly team-based clinical education and health care delivery landscape, and making core sociology content accessible for students coming in from laboratory science disciplines. We will tailor the workshop heavily to questions from attendees—so come prepared with things you've always wanted to know about teaching health professions students and ask away!

Panelists:

- Xan Nowakowski, Florida State University
- J. Sumerau, University of Tampa

73. Criminology and Criminal Justice [Regular Paper Session]

Saturday | 3:30 pm-4:45 pm | Virtual 1

Chair: Nicola Davis Bivens, Johnson C. Smith University

- *Mass Shooters and the Death Penalty: An Exploration of Sentencing Outcomes and Changes Over Time.*Adam Lankford, The University of Alabama, Tova Cohen, The University of Alabama
- *Hidden Perspectives: The Homeless Population and Their Perceptions of Unfair Police Treatment.*Chloe Catherine Davenport, Middle Tennessee State University, Vaun Baltimore, Middle Tennessee State University
- *Higher Education and Public Safety Organizations: Successful Collaborations for Diversity.*Nicola Davis Bivens, Johnson C. Smith University
- *In Search of a Place Called "Home": Domestic Violence, Homelessness, and Mobility Across the U.S. Legal Landscape.*Julio Richard Montanez, University of Central Florida
- *Restorative Justice: Understanding the Appeal of Supernatural Justice in Ghana.*Stella Korleki Apenkro, University of Tennessee, Knoxville

74. Investigating Inequalities and Social Movements [Regular Paper Session]

Saturday | 3:30 pm-4:45 pm | Virtual 3

Chair: Monica Bixby Radu, Southeast Missouri State University

- *Deinstitutionalisation, Neoliberalism and Urbanism: A Confluence of Neglect and Exploitation.*Ryan Harris, Georgia State University
- *"I Have No Family": A Qualitative Analysis of Crowdfunding for Pet Care Amidst Personal Hardships.*Monica Bixby Radu, Southeast Missouri State University
- *Historical-Comparative Analyses of Social Acceptance in the United States, Turkiye, and South Africa.*Ismail Yigit, Tennessee State University, Karin Abel, Tennessee State University
- *"Choices, Choices": The Struggle Between Identity and Orientation in the BDSM Community.*Alicia Walker, Missouri State University, Sawyer Ray Wampler, Missouri State University
- *Exploring Student Movements in Bangladesh in Relation to Political Environment through the Lens of Repression based Social Movements.*Aishwarya Ahmed, Oklahoma State University

75. Social Theory and History: Habermas' Legitimation Crisis after 50 Years - Theory Mini-Conference [Regular Paper Session]

Saturday | 3:30 pm-4:45 pm | Virtual 4

Organizer: Harry F. Dahms, University of Tennessee - Knoxville

Chair: Harry F. Dahms, University of Tennessee - Knoxville

- *What Hangs in the Anthropological Balance? On the Latent Phenomenology in Habermas's Crisis Theory.*Steven Dandaneau, Colorado State University
- *Habermas, Weber, and the Legitimacy of Communitarian Authority.*Dan Krier, Iowa State University
- *From Motivation to Desertion: Habermas, Berardi, and the Problem of Ethical Madness in Planetary Sociology.*Joel Crombez, Kennesaw State University
- *Prescience and Limits of Habermas' Legitimation Crisis.*Robert Antonio, University of Kansas

Index

Name (email): Session Numbers

Abbott, Jessica: 27,44
Abel, Karin: 74
Abney, Ayondayla: 62
Acharya, Sanjeev: 52
Aday, Ron: 27
Ademule, David Oluwashina: 15
Ahmed, Aishwarya: 74
Aitken, Lauren Nicole: 65
Akoma, Lemmy: 63
Alberty, Rebecca Rose: 4
Allen, Janeice: 48
Alvero, AJ: 63
Anderson, Kai: 16
Antonio, Robert: 75
Apenkro, Stella Korleki: 73
Appleford, Trenton: 62
Arthur, Jecorey: 19
Ashe, Austin W: 39
Asitibasi, Terence Amankatoa: 67
Austin, Andrew Wayne: 11
Authement, Catherine Rene`: 1
Baker, Mary: 38
Baltimore, Vaun: 24,27,73
Barker, Jessica: 10
Barnette, Lily: 35
Barrett, Adeline: 1
Barringer, Mandi N.: 64
Barton, Ashtin: 62
Barton, Chandleigh: 1
Beasley, Jaycob: 31
Bhattacharya, Sukanya: 29
Biddles, Emma: 15
Bisciglia, Michael: 46
Blanton, Natalie: 18
Bledsoe-Gardner, Anita: 33,54
Bonaparte, Yosef: 42
Borg, Marian: 63
Boulahanis, John: 4,46
Bounds, Chris: 2
Brackett, Kimberly: 32
Brooks, Marcus: 6,21,45,49,54
Brown, Amari Geneva: 39
Buchanan, Jareh: 48
Burke, Jessica Lynn: 7,16,31,36
Burzynski, Joe: 23

Bush, James: 52
Carter, Alicia: 43
Castillo, Sarah: 13,20,49
Chananie, Ruth: 11,43
Chang, I Joyce: 31
Chis, Ioana Cerasella: 70
Church, Jacob: 43
Clemens, Patrick: 36
Coheely, Joshua: 22
Cohen, Tova: 73
Condon, Roderick: 71
Cooper, Katie: 25
Cope, Madeline: 70
Copley, Emily: 62
Corbett, Christianne Marie: 47
Crockett-Woods, Harriet: 26
Crofts, Ethan Elliot: 35
Crombez, Joel: 5,13,29,57,75
Crouse, Angela Allgood: 52
Cucksee, Emil M: 31
Dahms, Harry F.: 13,22,29,57,61,66,71,75
Dandaneau, Steven: 57,66,75
Davenport, Chloe Catherine: 27,73
Davidson, Theresa Clare: 38
Davis Bivens, Nicola: 73
Davis, Rachel E.: 3,4,12,56
Davis, Stephen: 33,41
Davison, Rebecca K: 50
Deshotels, Tina: 3,5,47
Dhingra, Umang: 42
Dong, Ruohong: 63
Donley, Sarah Beth: 4,8,41
Douglas, Camara: 19
Downey, Liam: 69
Duxbury, Scott: 27
Dye, Meredith Huey: 27,42
Eadler, Valeria: 53,68
Eargle, Lisa A.: 7,16,36
Elliott, Christopher: 41
Emerson, Michael: 19
Escue, Melanie Anne : 5,16,36,45
Esmail, Ashraf: 7,16,34
Esquibel, Jimmy Joe: 39
Everhart, Katherine: 53,68
Fan, Jiabin: 21
Fannin, Casey: 8,41
Feltmate, David: 32
Ferguson, Kaitlyn Sarah Nicole: 35
Fitch, Matthew: 67
Foreman, Cameron: 45

Forsyth, Craig J.: 3
Frierson, Whitney: 52
Gaskin, Symone Micah: 2
Gay, Opal: 4
Ghosh, Debaleena: 70
Gibb-Clark, Stephanie: 61
Gitaliyev, Ülvi: 35
Golde, Eli: 38
Gomez, Gabriele Jaclyn: 64
Goza, Joel: 19
Graham, Cameron Taylor: 59
Greenidge, Giselle: 2,17,26,54
Greenslade, Vanessa: 5,37
Griffin, Lillian: 31
Haizlp, Matine: 18
Hanks, Roma: 8,33,67
Hardwick, Clay: 15
Harris, Chasidy: 13
Harris, Ryan: 74
Hart, Laura: 22
Hatton, Vannah: 21
Haynes, Stacy: 1
Heitkamp, Amanda: 14
Henricks, Kasey: 28
Hernandez-Ramos, Jaqueline: 63
Herrle, Emily: 31
Herrle, Emily Michele: 31
Himes, Monica: 50
Howard, Elliott: 21,29
Howard, Ryan Jackson: 63
Huff-Corzine, Lin: 46
Humble, Jenna Catherine: 2
Hunt, Andrea Nicole: 47,51,54
Iacobucci, Asa: 69
ibn-Hyman, Sundjata: 30,39
Imlay, Aimee: 52
Isom, Deena: 49
James, M. Kelly: 60
James, Tierra: 43
Johnson, Althestien: 10
Johnson, Kelsey: 18
Johnson, Mariyah: 30
Johnson, Melencia: 17,26,30,51,62
Jones, Emerald: 30
Jones, Nastassia N.: 26,41
Jones, Thomas Stafford: 67
Kadakal, Reha: 66,71
Kanopka, Klint: 63
Kelley, Nancy: 8
Kemper, Noelle: 14

Kersen, Thomas Michael: 7,11
Khan, Mahir Mahmud: 31
King, Sanna: 1
Knop, Katie: 63
Knowles, Anthony J.: 29,61
Knox, David: 31
Koontz, Amanda: 65
Kopf, Colby Ryan: 65
Krier, Dan: 66,75
Kumar, Naman: 42
Lampe, Nik: 25
Lancaster, Kailee E.D.: 6,43
Lang, David: 63
Lankford, Adam: 73
Lawrence, Sara: 23
Leetham, Ilaisa`ane: 35
Lehman, Brett: 14,32,44
Leonard, Marie des Neiges: 21
Lillis, J. Porter: 16
Lowry, Deborah: 59
Ma, Ying: 58
Mack, Michayla: 1
MacLean, Vicky M.: 6
Mangum, Maruice: 31
Marbang, Phattra: 20
Martin, Autumn Rena: 37
Martin, Cara Elizabeth: 36
Martinez Ramirez, Leonela: 43
Mason, Philip B: 59
Mathers, Lain A.B.: 25
May, David C.: 1,15,33
McCarty, Jessica: 30,55
McClain, Susan: 21
McClure, Timothy: 15
McCollum, John: 7
McCollum, John: 44
McGinley, Katie: 38
McGrath, Shelly: 5,27,31,34
McKinzie, Ashleigh: 28,37
McLaughlin, Heather: 4
McNett, Jacqueline: 32
Merrett, Ashton: 48
Mertig, Angela: 16
Mikles-Schluterman, Julie: 3
Miller, DeMond: 33,69
Miller, Lisa: 25
Min, Hosik: 67
Min, Hosik: 8
Mintz, Shara Anansa: 24
Modile, Adenife: 69

Moffatt, Barton: 15
Monk, Keziah: 45
Montanez, Julio Richard: 73
Moore, Christa: 65
Moore, Thomas: 60
Murray, Kimberly Michelle: 23
Napper, Sarah: 32
Nelson, Mikael Emmett: 18
Nicholas, Jennifer: 12
Nie, Fanhao: 64
Norman, Lauren: 9,32
Norton-Smith, Kathryn: 8
Nowakowski, Xan: 72
Noyongoyo, Boniface: 39
Nwoha, Ogbonnaya: 63
O`Neil, Shaun Patrick: 38
Ogunsina, Anjolaoluwa Joy: 64
Olufemi, Lola: 26
Padgett, Julian Aaron: 36
Pardee, Jessica W.: 28,67
Parker, Jeffrey: 69
Parker, Keith: 10,11
Patton, Andrea Rene: 35
Patton, Katie: 60
Pelfrey, Theresa: 32
Perkins, Elizabeth: 31,67
Perkins, Robert K. : 45
Perry, Kristie: 34,48
Petrie, Michelle: 59
Pohlmeier, Thomas: 14
Potter, Mike: 15
Powell, Chloe: 62
Prokosch, Marjorie: 28
Pyles, Micah: 69
Quebedeaux, Ciel: 69
Radu, Monica Bixby: 12,63,74
Rafalovich, Adam: 71
Rahman, Afra Sayara: 4
Rainock, Meagan: 2,37,52
Ralston, Margaret: 52
Raymond, Julietta: 12,34
Reeves, Patricia: 19
Reiter, Abigail: 58,69
Reiter, Miranda: 58
Rider, Erin L: 9,17,40
Ritter, Lacey: 31
Roberson, Sharon: 51
Robertson, Angela: 1
Robinson, Michaela Patsy: 37
Rodano, Colton: 2

Ross, Jeremy A: 22
Rowland, Aaron: 44
Samieva, Aziza: 69
Sanford, Edward: 43
Savage, Brenda: 64
Schlosser, Jennifer: 58
Schneider, Matthew Jerome: 9
Scott, Ashanti: 48
Seabold, Nicole: 27
Seay, Nancy: 19
Shrock, Peter John: 4
Simmons, Kiya Rayne: 22
Sims, Jennifer Patrice: 47
Skaggs, Sherry: 27
Skinner, Amy: 60
Slade, Teagan Ainsley: 31
Smith, David: 66
Smith, Jeremy: 13
Smith, Justin: 14
Sobba, Kristen Nicole: 58,63
Stacey, Lawrence: 6
Staten, Frances: 63
Stephens, Micaiah: 45
Stepp, Julie: 1
Stoner, Alexander: 57,61,66
Stowell, Kristen: 16
Sumerau, J. : 25,41,72
Sumlin, Cameron: 63
Swanson, Emily Katherine: 69
Tallichet, Suzanne: 67
Tasneem, Farah: 20,64
Tatch, Andrew James: 14
Thomas, Angela-Faith: 4
Tjarks, Kirsten: 31
Toohy, Kayla: 46
Traugot, Michael: 60
Turgeon, Brianna: 4,43
Ulsperger, Jason Shawn: 8,22
Ulsperger, Kristen: 22
Veitch, Stanley Adam: 43
Vera, Nadya: 61
Vergara, Angela: 20
Vicars, Ariel: 43
Vickerman, Milton: 69
Vincent, Jolene: 14
Viscarra, Eryn Grucza: 3
Waid, Courtney: 32
Walker, Alicia: 70,74
Walter, Jess: 47
Walton, Charles: 57

Wampler, Sawyer Ray: 74
Warren, Lauren: 37
Watts, Alex: 42
Weaver, Nakaja: 65
Wells, Makeela Johari: 59
West, Matthew : 14,60
White, Neil Robert: 7
Williams, Ashley: 8
Williams, Sania: 2
Williamson, Abby Gray : 67
Wilson, Fletcher Nicholas: 42
Wilson, Marshall: 48
Wisecup, Aida: 58
Woodward, Andrea: 35
Wright II, Earl: 30,54
Wyatt, Likita: 60
Yigit, Ismail : 45,74
Yucel, Deniz: 70
Zhang, Shaohu: 16

*Winner of the
2021
Stanford M.
Lyman
Distinguished
Book Award*

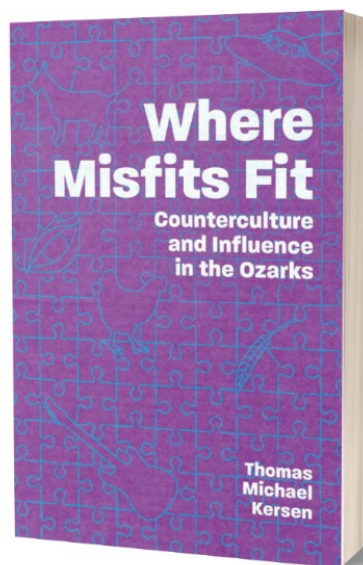

*Where Misfits Fit
Counterculture and Influence in the Ozarks
Thomas Michael Kersen*



Disasters and emergencies demand experts

For students intent on protecting critical infrastructure, crisis management, enhancing cybersecurity, disaster public health and pandemic response, and recovery from natural disasters, the program in Disaster Science & Emergency Management at Rowan University offers a world of options at the undergraduate and graduate levels. Exceptional classroom experiences, coupled with practical research opportunities and internships, prepare tomorrow's sought-after professionals and respected leaders in the field of Emergency Management.



rowan.edu

CELEBRATING MSSA AUTHORS

Chtouris, Sotiris and DeMond S. Miller. 2024. *Diagnosis in Social Fields and Networks*. Springer Nature, Switzerland.

Deshotels, Tina. 2022. *Gendered Power Dynamics and Exotic Dance: A Multi-level Analysis*. Routledge.

Deshotels, Tina H., Forsyth, Craig J., Rider, Erin. 2024. *Crime and Deviance: Understanding Problems, Constructing Solutions*. Cognella Academic Publishing.

Kersen, Thomas Michael. 2021. *Where Misfits Fit*. University Press of Mississippi.

Knottnerus, J. David. *Polar Expeditions: Discovering Rituals of Success Within Hazardous Ventures*. 2023. Routledge.

Knox, David. 2024. *Choices in Relationships*, 14th ed. Sage.

Knox, David. 2024. *Human Sexuality: Making Informed Decisions*, 7th ed. Best Value Textbooks.

McGrath, Shelly. 2023. *Understanding Statistics for Criminal Justice and the Social Sciences*. Kendall Hunt Publishing Company.

Thorpe Jr., Roland J. and DeMond S. Miller. (2024). *Health Disparities, Disasters, and Crises: Approaches for a Culture of Preparedness*. Routledge. New York, NY.

Ulsperger, Jason. 2022. *The 53: Rituals, Grief, and a Titan II Missile Disaster*, Lexington Books.

Walker, Alicia. 2020, *Chasing Masculinity: Men, Validation, and Infidelity*. Palgrave.

Walker, Alicia. 2017. *The Secret Lives of Cheating Wives: Power, Pragmatism, and Pleasure in Women's Infidelity*. Lexington Books.

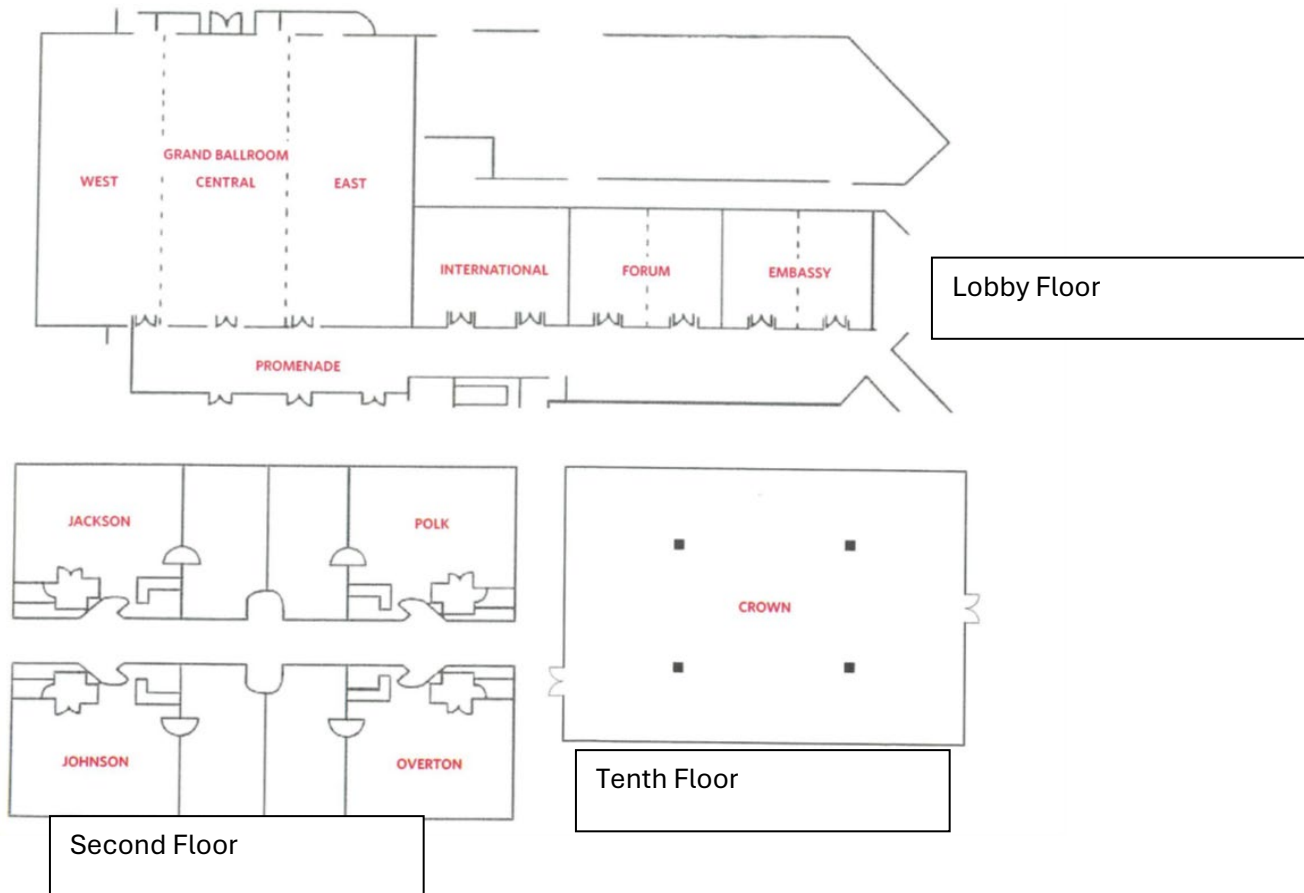

HIGH-DEMAND SKILLS
WELL-PAID JOBS
SOLVING SOCIAL PROBLEMS

**DRIVE THE CONVERSATION
IN A DATA-DRIVEN WORLD!
APPLIED SOCIAL RESEARCH
GRADUATE CERTIFICATE**

WHAT: STAND-ALONE CERTIFICATE OR TAKE
ALONGSIDE A MASTER'S OR PH.D. PROGRAM

WHO: STUDENTS WITH A BACHELOR'S,
BEGINNING-LEVEL SKILLS IN STATISTICS/RESEARCH
METHODS, AND ACCEPTABLE COLLEGE GPA

MIDDLE TENNESSEE STATE UNIVERSITY I AM true BLUE mtsu.edu/soc

Middle Tennessee State University does not discriminate on the basis of race, color, national origin, sex, or disability. See our full policy at mtsu.edu/soc.

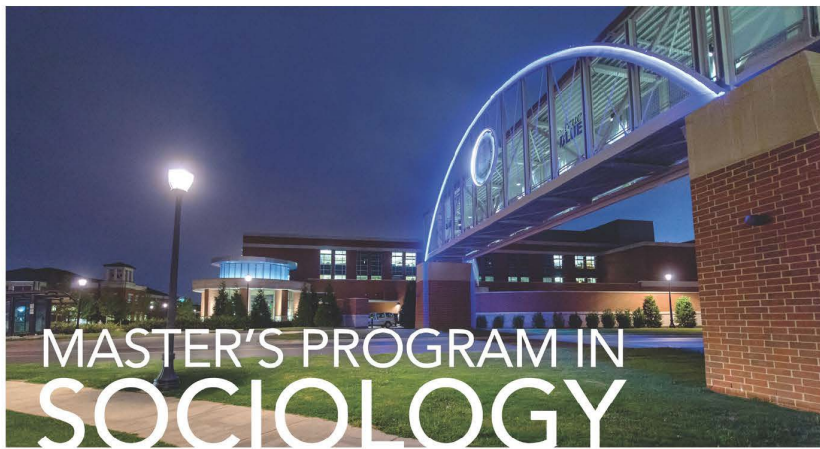

MASTER'S PROGRAM IN SOCIOLOGY

Are you seeking a program that provides

- A variety of **specialty choices**?
- Close **faculty-student mentor** relations?
- Grounding in **applied social research methods**?
- A strong and **engaged student body**?
- Opportunities for **research and publication**?

MTSU Sociology is here for you!

mtsu.edu/programs/sociology-ma

Specialized Study

- Applied social research
- Deviance and criminology
- Environment, disasters, and collective behavior
- Families and leisure
- Gender and sexuality
- Gerontology and aging
- Health and illness
- Work and organizations
- Race and ethnicity
- Social inequality and social movements

**MIDDLE
TENNESSEE**
STATE UNIVERSITY,
I AM *true* **BLUE**

Aiken

UNIVERSITY OF SOUTH CAROLINA



**The College of Arts, Humanities, and Social Sciences
and the Department of Sociology**

proudly supports the

**MSA Mid-South Sociological
Association**
Promoting Excellence in Teaching, Research, and Service

ADDITIONAL INFORMATION

The information presented in this conference program, including details about speakers and their presentations, is provided to the best of our knowledge. While we strive for accuracy, we cannot guarantee that all content is free from errors or omissions. The views and opinions expressed by presenters are their own and do not necessarily reflect those of the conference organizers.

Please note that all registration fees must be paid in full prior to participation in the conference.

In our ongoing effort to promote sustainability and reduce our environmental impact, we are making significant changes to our conference materials this year. We are committed to minimizing printing by providing digital resources wherever possible. Additionally, instead of traditional bags, we will be offering binder clips for you to conveniently hold your conference materials.

We encourage all attendees to embrace these changes as part of our collective responsibility to protect the environment.

Selected abstracts from the conference will be published in *Sociological Spectrum*. The pool of abstracts only includes those whose authors agreed to have their abstract published. By submitting an abstract and selecting yes to the question on the registration form, presenters agreed to this publication and grant the necessary rights for dissemination.

By attending this conference, you acknowledge that photographs and videos may be taken during sessions and events. These images may be used for promotional purposes, including but not limited to publications, social media, and future marketing materials for the conference.

If you do not wish to have your image recorded, please inform the event staff at the registration table. Thank you for your understanding and cooperation. We look forward to capturing the spirit of the conference!

Thank you for your understanding and support. We look forward to a successful event!

SEE YOU NEXT YEAR IN SOUTH CAROLINA!



EVER FORWARD!

The nation's third fastest-growing public research institution and a top 100 public university, Rowan offers bachelor's through doctoral and professional programs in person and online to more than 22,000 students. Focused on practical research at the intersection of health care, STEM and business, Rowan is committed to excellence in undergraduate education.

rowan.edu

ZOOM GUIDE FOR MSSA VIRTUAL CONFERENCE ATTENDEES

OCTOBER 19, 2024

Virtual sessions will use the Zoom Meeting platform. Joining a Zoom meeting is free; follow the steps below:

1. Obtain the link to the session or event you wish to join. See specific session listing for link.
2. All times are U.S. Central Standard Time
3. What you need: A computer, tablet, or smart phone with (reliable) internet connection. Note that instructions differ somewhat depending on what device you are using to attend (see instructions to participate by device type below).
4. There are two ways to join on Zoom. The first is to click the weblink provided, and the second is to join by opening the Zoom app and manually entering the meeting ID.
 - Option 1: Click the meeting link:
 - a. If you are prompted to download the Zoom app, do so.
 - b. Once the app is installed and open, you may be prompted to enter a passcode, so have that information handy.
 - c. If prompted, type in your name.
 - d. Click “join meeting” (with or without video).
 - Option 2: Join manually using the Zoom app:
 - a. Open the Zoom app on your device.
 - b. If you do not have the app, you can find it here <https://zoom.us/> or in the app store on your phone or tablet.
 - c. Once Zoom is open, click “join a meeting” and enter the meeting ID, then click “join.” On the next screen, you will be prompted to enter the passcode.
 - d. If prompted, type in your name.
 - e. Click “join meeting” (with or without video)
5. Participating by Device Type once you have joined the meeting:
 - Computer: When you are in the Zoom room, move your cursor to the bottom of the Zoom screen, and control options will pop up.
 - a. Mute/Unmute – It is good protocol to remain muted unless you are talking, to minimize background noise.

- b. Start/Stop Video – Turns your camera on and off.
 - c. Participants – click this to see a white screen on the right side that lists everyone in the room.
 - d. Chat – click this to enable the chat box. This allows you to type messages to the host or other participants, depending on security settings.
 - e. Speaker/Gallery view – up in the righthand corner, you will see a button called “speaker view.” Click that to see the current speaker’s screen enlarged. Click on the little square box next to it to return to Gallery view.
 - f. To request to speak – click on the “reactions” button on the bottom, then click “raise hand”.
 - g. To leave the meeting, click the red “leave” button on the bottom.
- Smart Phone/Tablet
 - a. Once in, you may have to connect your audio manually. Select “Dial in” and choose one of the numbers presented. Ignore requests to enter meeting ID etc. – just wait and you will be connected to the audio of the meeting. (read the fine print at the bottom of the number list, it tells you this)
 - b. Once you are all in and connected, to see the controls, touch or swipe the bottom of the screen and they should pop up. They work pretty much the same as on the computer (see computer instructions above), except you won’t be able to see everything or everyone at the same time.

6. Technical Requirements and Support:

- NOTE: MSSA’s Technology Committee cannot provide direct technical support for your specific device or your internet connection. However, we have a few recommendations and some Zoom support links below.
 - General recommendations for optimal Zoom experience: The newer your device and operating system, the better. Generally, if it is more than 2 years old you are more likely to experience technical difficulties. On PC computers, we recommend using Chrome as your browser.
- a. If you are experiencing problems, we recommend that you reboot or restart your device, as that often helps.
- Zoom support website: <https://support.zoom.us/hc/en-us/categories/200101697>
 - System Requirements for Computer: <https://support.zoom.us/hc/en-us/articles/201362023-System-requirements-for-Windows-macOS-and-Linux>
 - System Requirements for Phone/Tablet: <https://support.zoom.us/hc/en-us/articles/201362023-System-requirements-for-Windows-macOS-and-Linux>

ZOOM GUIDE FOR SESSION PRESIDERS

ALL TIMES U.S. CENTRAL DAYLIGHT TIME

On the program schedule (<https://mssa.mymeetingsavvy.net/program>) there are 5 blocks of 5 concurrent sessions. The first round of sessions begins at 8:00 AM (CDT) and the day will end at 5:00 PM (CDT), with sessions running for 75 minutes each.

Virtual presiders and/or participants may join on Zoom using the links in the program. Presiders/chairs, please help with the following:

- Please make sure all participants have "screen sharing" privileges.
- Please make sure the captions are turned on for accessibility.
- Please make sure the "Waiting Room" is disabled.
- Introduce the session and presenters just as you would if in person. Please remind attendees to mute themselves when not participating.
- To share their screen for slide presentations, the presenter should click on the green "share screen" icon at the bottom of the Zoom screen (if they can't see it, they can hover their cursor over the area and the icons will appear).

If they have video, remind them to make sure "optimize for video clip" is checked on the screen share settings.

- Please be cognizant of the end time of the session, in order to make way for the incoming session, which will be on the same Zoom channel.
- Please reassign "host" or "co-host" privileges to the incoming presider/chair or volunteer.

For tech support contact Marcus Brooks.

Taylor & Francis celebrates the 50th Anniversary of MSSA

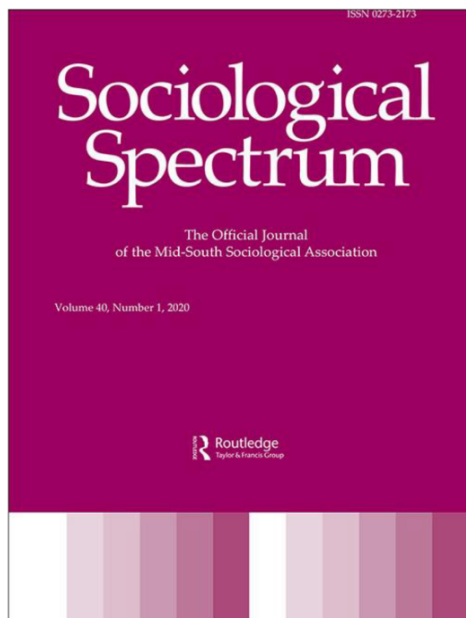

Sociological Spectrum is published as part of a long-standing relationship between Taylor & Francis and Mid-South Sociological Association.

The journal publishes papers on theoretical, methodological, quantitative and qualitative research, and applied research in areas of sociology, social psychology, anthropology, and political science.

Submissions welcome

Visit the journal's homepage for more information, including:

- Journal metrics
- Editorial board
- Submission information
- News & calls for papers



tandfonline.com/usls



Taylor & Francis
Taylor & Francis Group